

VARUN IMPEX
Solutions for Furniture Industry



Bed Fittings

03-08



Wardrobe Fittings

09-15



Kitchen Accessories

16-34



Other Accessories

35-38

VARUN IMPEX

Varun Impex is set up by professionals with a rich experience of **14 years** customer-focused company which dedicated to providing the finest quality hardware to the furniture industries at competitive prices, by introducing the best of Italian trends and innovation from Italy's most premium and distinctive brand companies by its import division from **Vibo** for Kitchen accessories, **Volpato Industries Srl** for Anti-Slip mat, Sink and Fridge base, Plinth and Legs, Gola profiles, **Eureka Srl** for Handles and Shelving systems, **Elletipi Srl** for Waste bins & Dish Racks, **System Holz** for Sliding Wardrobe mechanisms, Hinges, Overmax, **Pessotto Reti** for Bed Frames & Mechanism, **Grass** (Austria) for Drawer System and **Barazza Srl**, a premium brand for Ovens, Hobs and mainly from **Italy**.

Varun Impex proposes to its customers a specific product range, which gives them the opportunity to be competitive in a unique and exclusive way.



Brands represented
in INDIA

BARAZZA
taste of design

elletipi

EUREKA

G*GRASS
(Made In Austria)

PESSOTTO

SH System Holz

VOLPATO

VIBO

BED FITTINGS

SYSTEMS FOR STORAGE BEDS

Aladino Hideaway Double Bed Manual Version



Aladino is a functional and comfortable hide-away bed with a smooth balanced manual opening. Developed for a daily use, its strength is given by the use of important tube profiles, which prevent the doors from bending, granting a long lifetime over the years, For cabinets with inside closing front. It can be completed by a collapsible sofa set.

- Available in size:**
- Double (Vertical) Bed size 1620mm x 2000mm



MANUAL VERSION: TECHNICAL DETAILS

Bedspring	1620mm
Mattress size	1600 x 2000mm
Bedspring weight	38Kgs
Mattress average weight	28Kgs
Footboard panel weight	7Kgs
Front panel weight	32Kgs
Internal cabinet size	2175 x 1705 x 380mm

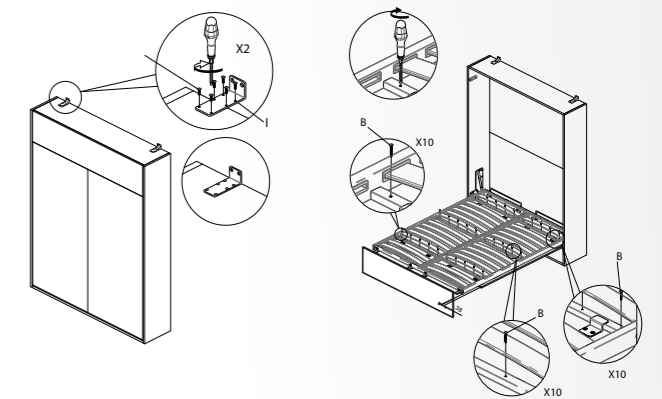

NOTE: Please ensure the weight balance (Front panel + Footboard panel) does not exceed 47.5kgs, If the weight exceeds the mattress weight has to be reduced in its accordance.

Aladino Hideaway Sofa Cum Bed Manual Version



Aladino is a functional and comfortable hide-away bed with a smooth balanced manual opening. Developed for a daily use, its strength is given by the use of important tube profiles, which prevent the doors from bending, granting a long lifetime over the years. For cabinets with inside closing front. It can be completed by a collapsible sofa set.

Available in size:

- Double (Vertical) Bed size 1620mm x 2000mm



Gas springs



Polymer cover

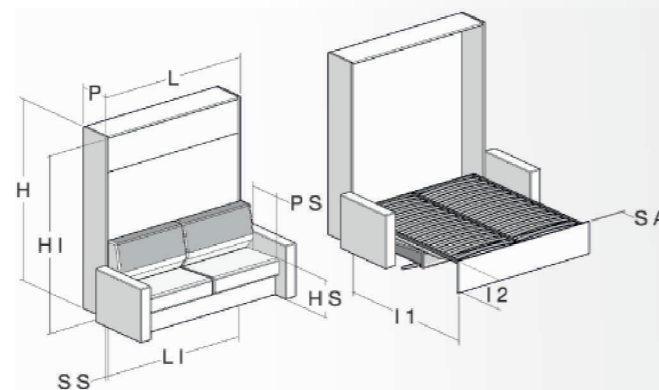

MANUAL VERSION: TECHNICAL DETAILS

Bedspring	1620mm
Mattress size	1600 x 2000mm
Bedspring weight	38Kgs
Mattress average weight	28Kgs
Footboard panel weight	7Kgs
Front panel weight	32Kgs
Internal cabinet size	2175 x 1705 x 380mm

NOTE: Please ensure the weight balance (Front panel + Footboard panel) does not exceed 47.5kgs, If the weight exceeds the mattress weight has to be reduced in its accordance.

Aladino Hideaway Bed Single Vertical Manual Version



Aladino is a functional and comfortable hide-away bed with a smooth balanced manual opening. Developed for a daily use, its strength is given by the use of important tube profiles, which prevent the doors from bending, granting a long lifetime over the years. For cabinets with inside closing front.

Available in sizes:

- Single (Vertical) Bed size 870mm x 2000mm



MANUAL VERSION: TECHNICAL DETAILS

Mattress size	870 x 2000mm
Bedspring weight	18.1Kgs
Mattress average weight	14.5Kgs
Footboard panel weight	4.2Kgs
Front panel weight	20Kgs
Internal cabinet size	2175 x 955 x 400mm

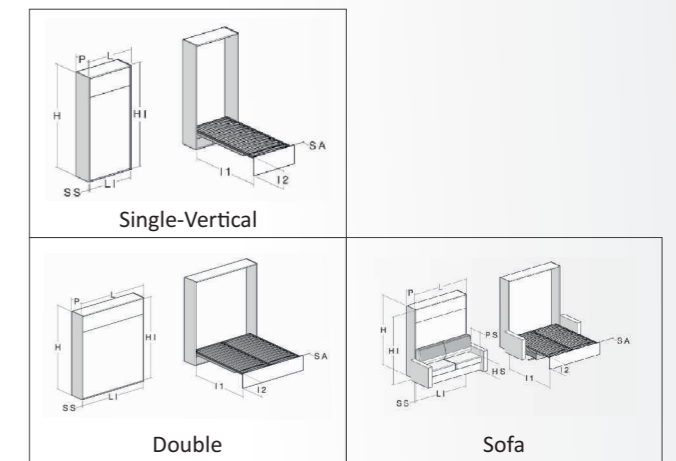

NOTE: Please ensure the weight balance (Front panel + Footboard panel) does not exceed 24.2kgs, If the weight exceeds the mattress weight has to be reduced in its accordance.

Aladino Hideaway Double Bed Motorized Version



Aladino is a functional and comfortable hide-away bed with a smooth balanced manual opening. Developed for a daily use, its strength is given by the use of important tube profiles, which prevent the doors from bending, granting a long lifetime over the years, for cabinets with inside closing front.

Available in size:

- Double (Vertical) size 1620mm x 2000mm

Motorized Mechanism

The **Motorized Hideaway Bed's** movement happens by means of two engine put on the sides of the structure, and recline the bedspring and by other two gas springs which recline the upper panel, that becomes the bed's footboard.



TECHNICAL DETAILS

Bedspring	1620mm
Mattress size	1600 x 2000mm
Bedspring weight	32Kgs
Mattress average weight	28Kgs
Footboard panel weight	9.5Kgs
Front panel weight	38Kgs
Internal cabinet size	2175 x 1705 x 360mm

NOTE: Please ensure the weight balance (Front panel + Footboard panel) does not exceed 47.5kgs, If the weight exceeds the mattress weight has to be reduced in its accordance.

Aladino Hideaway Sofa Cum Bed Motorized Version



Aladino is a functional and comfortable hide-away bed with a smooth balanced manual opening. Developed for a daily use, its strength is given by the use of important tube profiles, which prevent the doors from bending, granting a long lifetime over the years, For cabinets with inside closing front. It can be completed by a collapsible sofa set.

Available in size:

- Double (Vertical) size 1620mm x 2000mm

Motorized Mechanism

The **Motorized Hideaway Bed's** movement happens by means of two engine put on the sides of the structure, and recline the bedspring and by other two gas springs which recline the upper panel, that becomes the bed's footboard.



TECHNICAL DETAILS

Bedspring	1620mm
Mattress size	1600 x 2000mm
Bedspring weight	32Kgs
Mattress average weight	28Kgs
Footboard panel weight	9.5Kgs
Front panel weight	38Kgs
Internal cabinet size	2175 x 1705 x 360mm

NOTE: Please ensure the weight balance (Front panel + Footboard panel) does not exceed 47.5kgs, If the weight exceeds the mattress weight has to be reduced in its accordance.

Pratik Storage Bed Fitting



Horizontal elevation functions permits free movement which makes the task of bed making comparatively easier. Stabilizing bar provides optimal stability. Comfortable opening enables free handling of things in the storage space. It is available in three different sizes.

Frame size: 1530mm x 1905mm

Cabinet size	1560 x 1950mm
Cabinet height	Min. 280mm
Weight of mattress	32 - 35Kg

Frame size: 1680mm x 1980mm

Cabinet size	1710 x 2025mm
Cabinet height	Min. 280mm
Weight of mattress	32 - 35Kg

Frame size: 1830mm x 1980mm

Cabinet size	1860 x 2025mm
Cabinet height	Min. 280mm
Weight of mattress	32 - 35Kg

Horizontal elevation

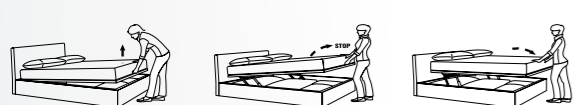

Total opening

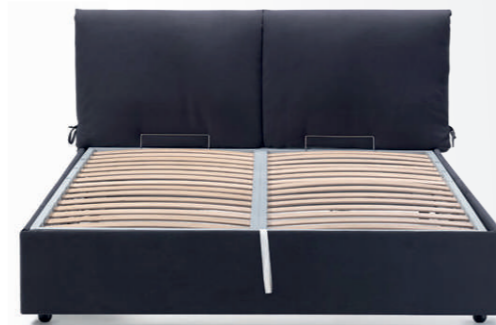
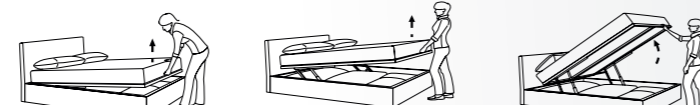

Giove Storage Bed Fitting

Create an extra storage area. Easy to install and access. Simple to open and close. It is available in three different sizes.



Frame size: 1530mm x 1905mm

Cabinet size	1560 x 1935mm
Cabinet height	Min. 280mm
Weight of mattress	35 - 40Kg

Frame size: 1680mm x 1980mm

Cabinet size	1710 x 2010mm
Cabinet height	Min. 280mm
Weight of mattress	35 - 40Kg

Frame size: 1830mm x 1980mm

Cabinet size	1860 x 2010mm
Cabinet height	Min. 280mm
Weight of mattress	35 - 40Kg

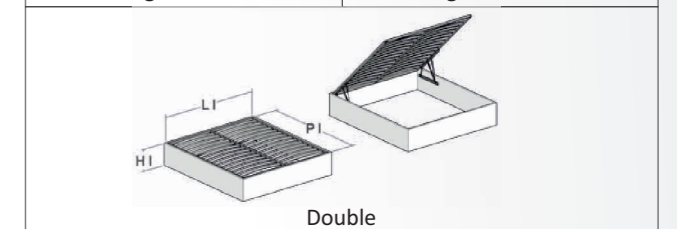
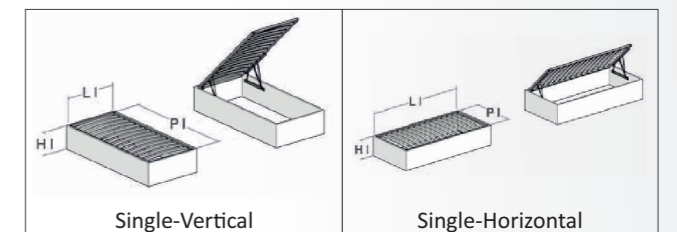

Alby Bed Fitting

Alby - M

Automatic pull-out bed with head pull and headboard single models. Front panel floor-covering wheels Bed with slats.

Reduced high: Open 35cm
Closed 12cm



Unit size: 800mm x 1900mm

Bedspring height	320 - 350mm
Cabinet size	900 x 1950mm
Weight of mattress	15Kg



Top with slats



Curved metal profile



Brackets for front panel fastening



No-trace wheels

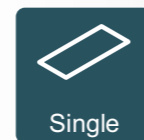
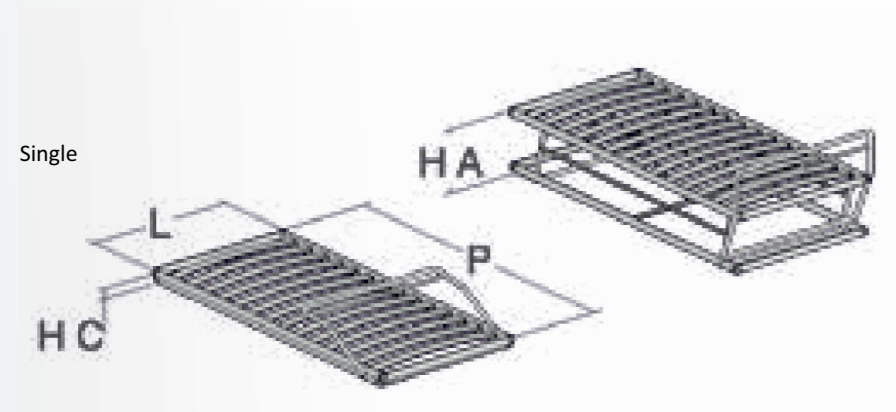

Single

75x185 cm
80x185 cm
80x190 cm



40x30

Profile

Alby Bed Fitting

Alby - L

Automatic pull-out bed with side pull and headboard single models. Front panel floor-covering wheels Bed with slats.

Reduced high: Open 35cm
Closed 9.5cm

Unit size: 800mm x 1900mm

Bedspring height	320 - 350mm
Cabinet size	900 x 1950mm
Weight of mattress	15Kg



Top with slats



Curved metal profile



No-trace wheels

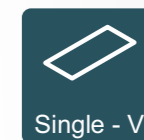
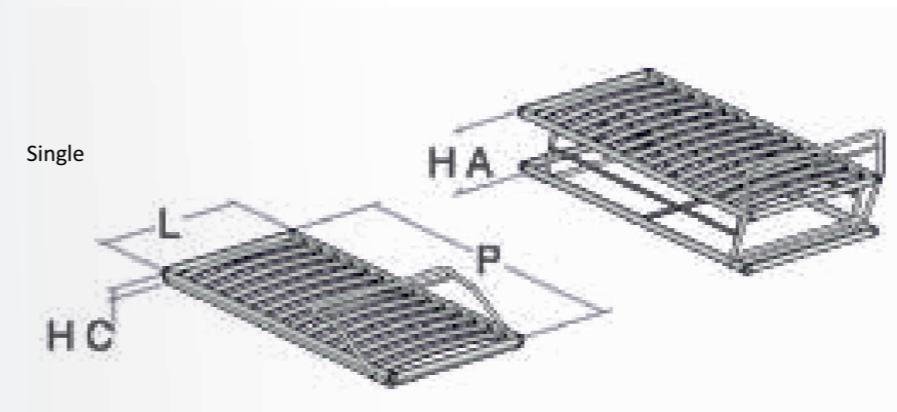

Single - V

75x185 cm
80x185 cm
80x190 cm



30x33

Profile

HOTEL BEDS

Hotel Bed Fitting

Finished structures and self-supporting frames. Easy to install and access.

Unit size: 1830mm x 1980mm

Legs height	300mm
Weight of mattress	35Kg



Top with slats



Extruded aluminium corners

Single

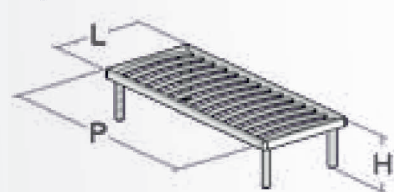

Double

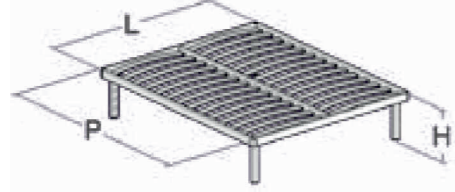

60 x 30

Profile

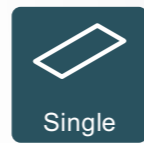

Single

80x190 cm
90x200 cm



Double

160x190 cm
160x200 cm

WARDROBE FITTINGS



Walk-in-Wardrobe



Aluminium Bar: Code 3520

Dimension: L: 3000mm x D: 53mm x W: 16mm

Product Feature:

- *aluminium bar with length 3000mm.
- Application:** Wardrobes, Shelving, Bookshelf, TV Entertainment units, Office/desk, Shop.

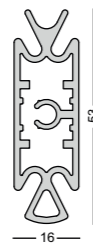

Glass Shelf Bracket: Code 3522

Product Feature:

- *It is used with shelf holder.
- *To be use in conjunction with flat shelf holder.
- *1 set consist-glass shelf bracket.
- *1 anti scratch plate.
- *Two transparent gasket & 1 screw.

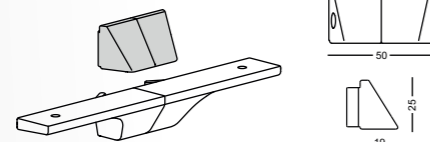

Shelf Holder: Code 3521

Dimension: L: 160mm x D: 22mm x W: 22mm

Product Feature:

- *Shelf holder 160mm.
- *Able to attach wooden shelf & drawer.
- *Anti scratch plate.

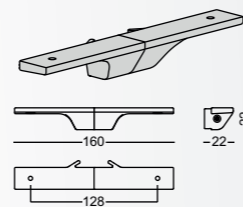

Adjustable Foot: Code 3523

Product Feature:

- *Foot can be adjusted by max. 15mm in length.
- *1 set consist-1 foot bracket, 1 self threading screw and 1 adjustable foot.

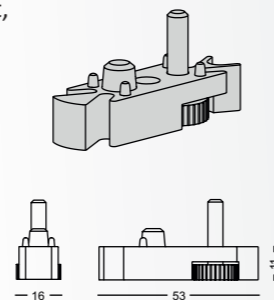

Corner Joint Wall Connector: Code 3524

Product Feature:

- *1 set consist-one corner joint & 1 wall connector.

Application: It is used with from wall to wall floor to wall corner joint.

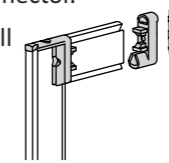

Tube Holder: Code 3529

Product Feature:

- *Fully adjustable in height.
- *Suitable for wardrobe rail.

Width: 15mm x **Height** 30mm

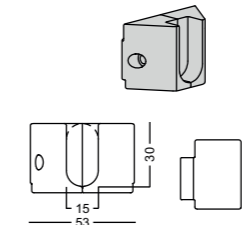

Intermediate Support: Code 3532

Product Feature:

- *Can be positioned at any height.
- *It's used for fix with ceiling connector and attach to the aluminium bar.
- *Eliminates any effect ragged in aluminium bars large.

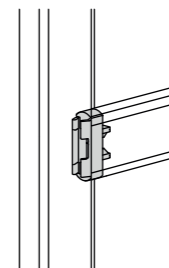

Sloping Shelf: Code 3428

Product Feature:

- *Designed for wooden shelves only.
- *Perfect to create shoe racks, magazine displays.
- *Allows to create a shelf on all angles.

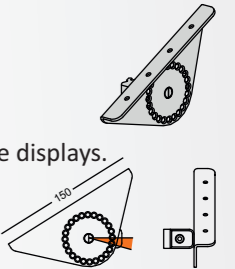

Desk Bracket: Code 3449

Dimension: W: 445mm D: 33mm H: 33mm

Product Feature:

- *Drills directly into wall.
- *Positioned up to the shelf holder with wooden shelf support available in Pairs.

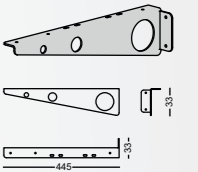

Walk In Wardrobe is a Functional Space & A Stylish Furnishing Solution for your Home. Different Ways of Installation Allows System to fit in all Spaces & Create Functional & Original Settings.



Sliding Wardrobe Bridge System 500

Bridge system 500 - Two door sliding size 8ft. x 8ft.

Bridge system 500 - Two door sliding size 9ft. x 9ft.

Product Feature:

- *Maximum capacity of 60Kg.
- *Suitable for both wooden or aluminium framed doors.
- *Available two door sliding doors mounted inside the cabinet with soft-closing dampers.
- *The aluminium frame profiles are designed to work with 4mm thick glass with standard gasket or up to 10mm wood panels without the gasket.
- *The aluminium frame profiles can be cut to suit the desired door sizes.



500 offers three different kind of vertical handle profiles. The profiles 010662 and 010884 work with the same accessories, while for the profile 010702 different accessories are available.



Junction Elements for the Horizontal Crosspieces Assembling

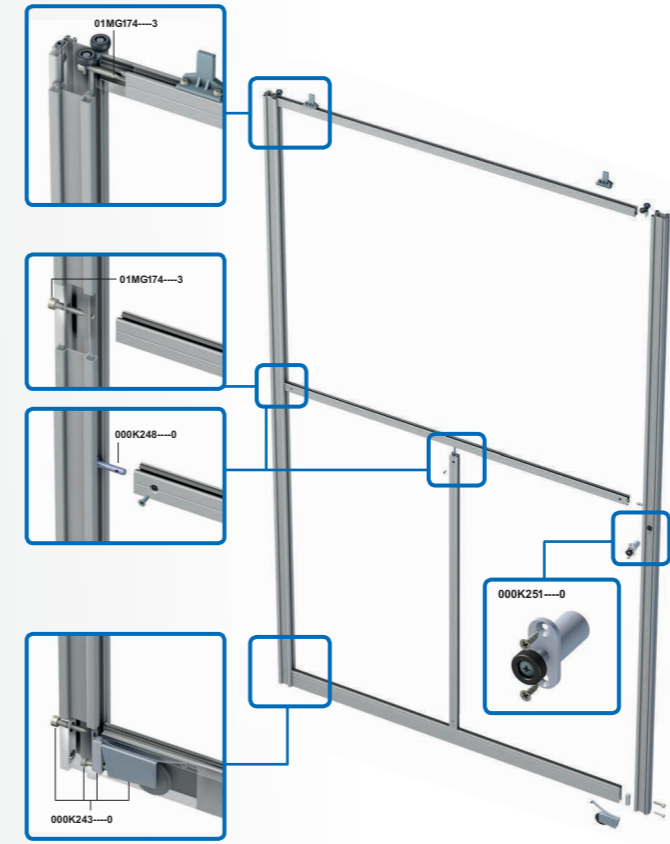

Soft-closing Dampers Insertion In The Upper Rail

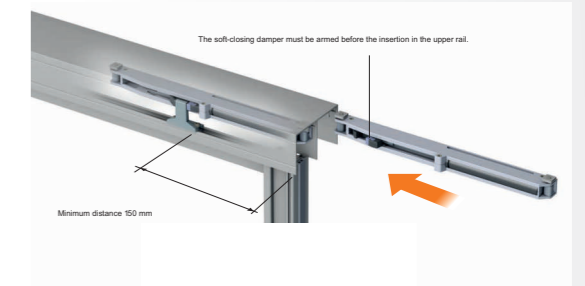

TRADITIONAL STOPPERS INSERTION IN THE UPPER RAIL

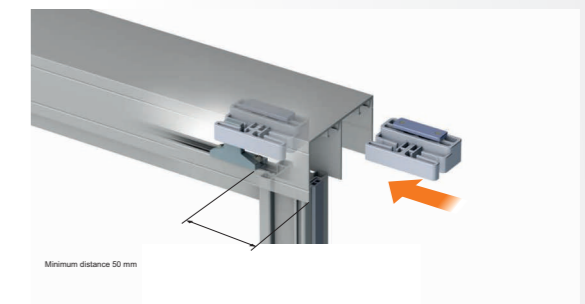

Calculation Formulas To Get The Door Sizes According To The Vain Measurement

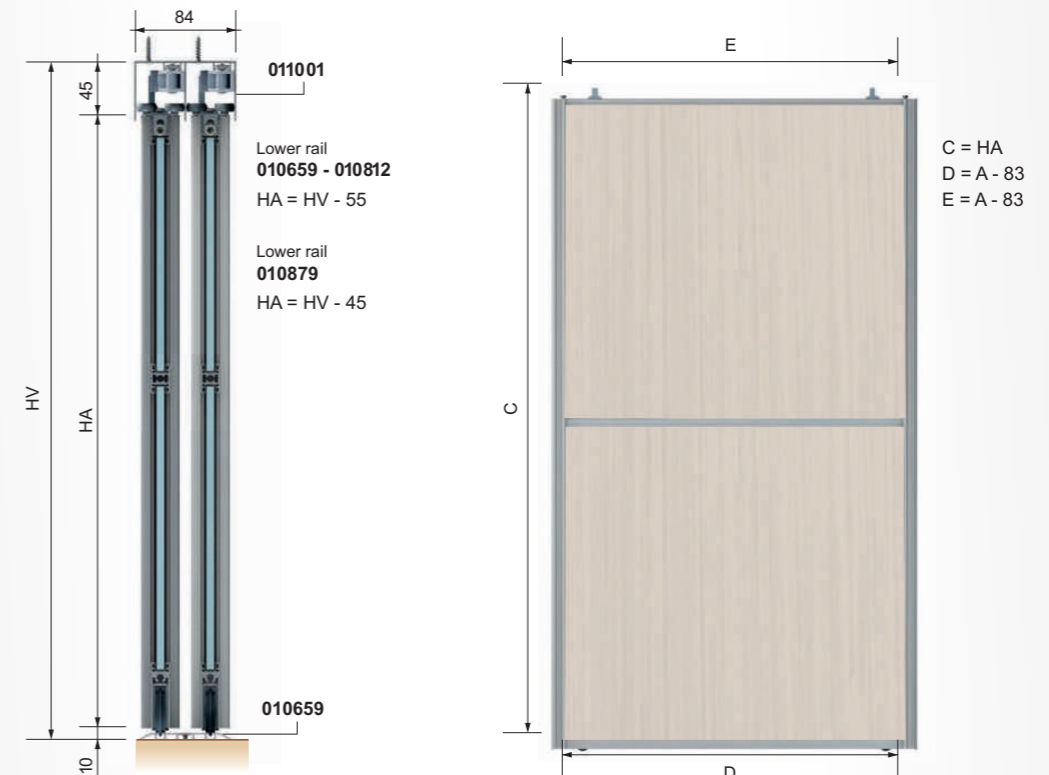

Smart Cube

Float is an extremely versatile aluminium system that allows you to create an endless range of furnishing and furnishing solutions.

Product Feature:

1. Only two aluminium profiles
2. Modularity
3. Quick mounting
4. Suitable for shelves from 4 to 19mm thickness
5. With glass safety lock
6. Available in different finishes
7. Profiles available in bars

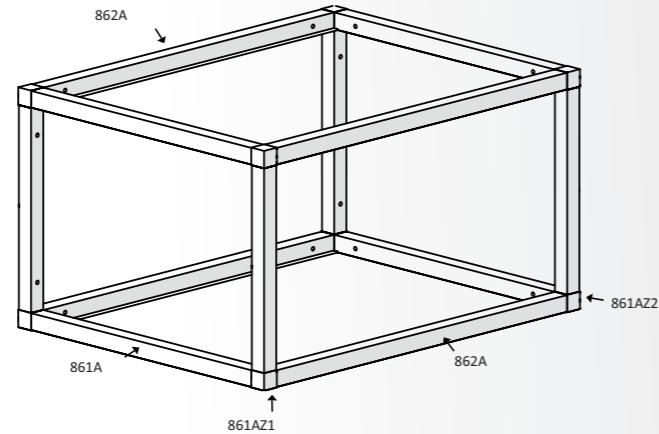

Profile are also available in bars and this allows an utmost customization thanks to a variety of accessories.

COMPONENTS

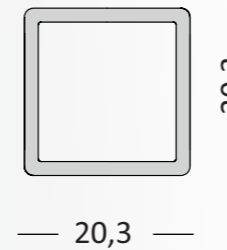

Code 861A
Aluminium Profile

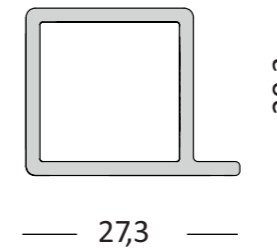

Code 862A
Aluminium Profile

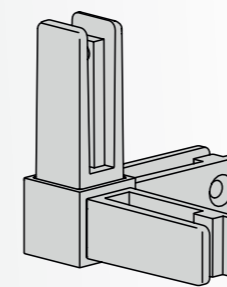
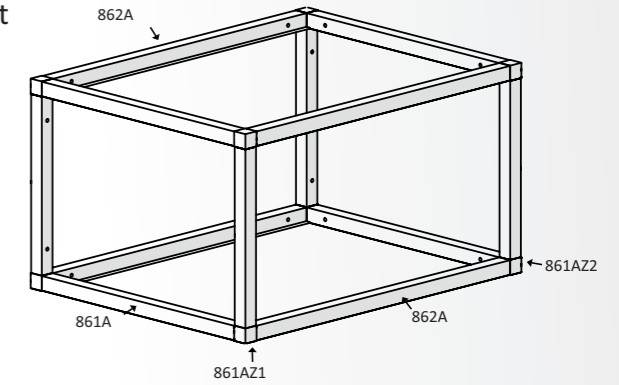

Code 861AZ1
Code 861AZ2
3-Way Corner Joint

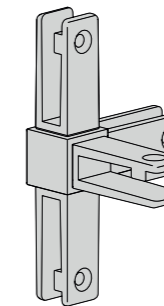

Code 861AZ3
Code 861AZ4
4-Way Corner Joint

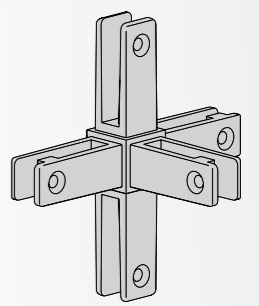

Code 861AZ5
5-Way Corner Joint

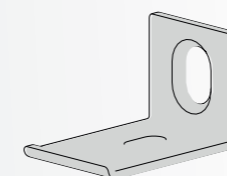

Code 862AF1
Metal Plate (Price Per Pair)



Code FERRAM
Profiles Special Screw

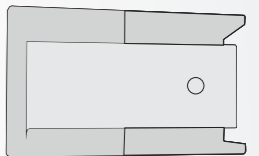

Code 861AP1
Drilling in ABS

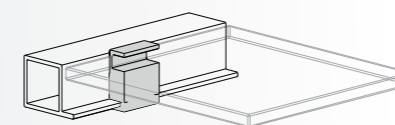

Code 862AK1
Glass Shelf Bracket

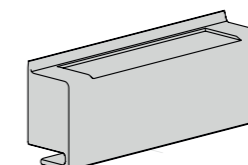

Code 862AK2
Shelf Spacer (Espesor 8 to 16 mm)

Wall Cladding System

Accessories for Wall Cladding System Fast Coupling System For Cladding Panels



Example of Frames

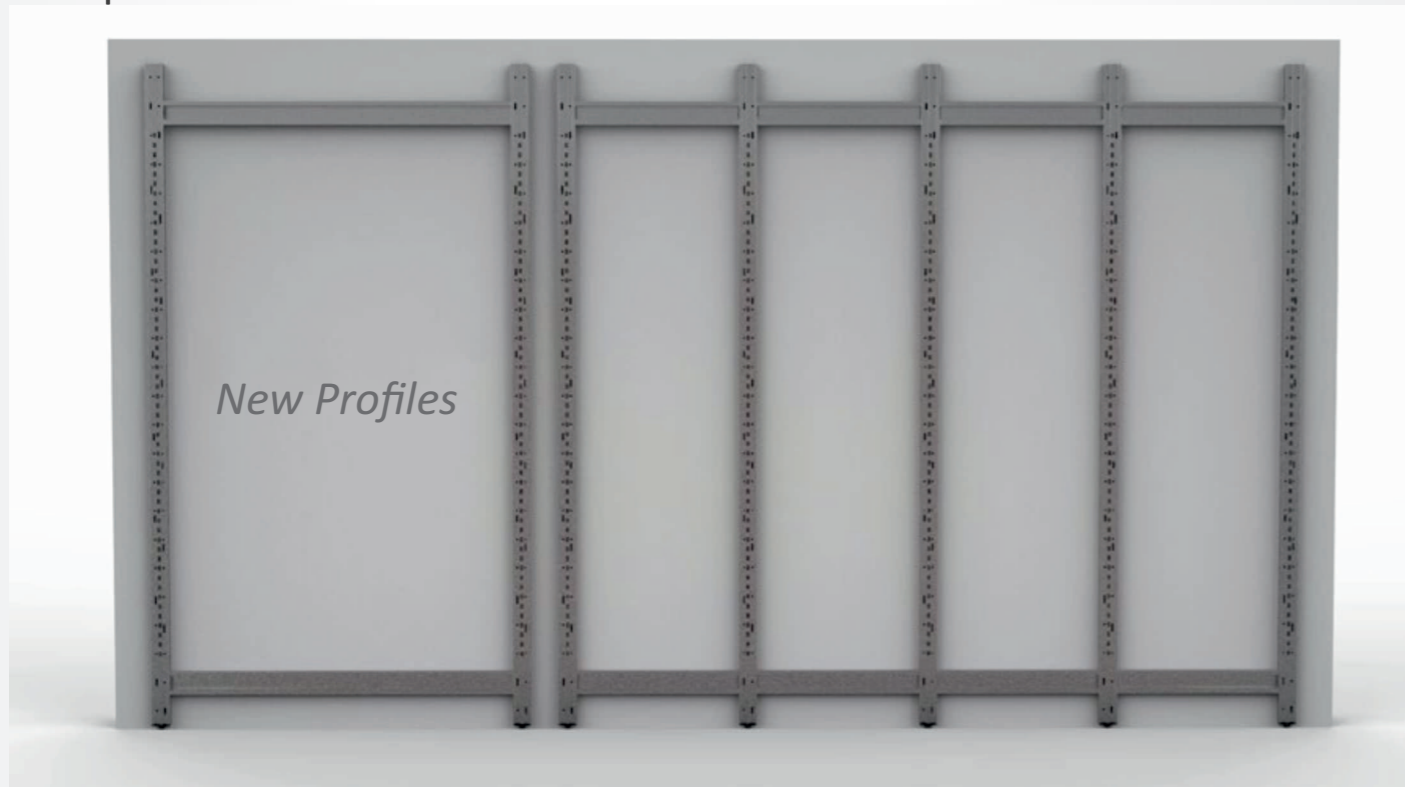

New Accessories Assembly



Bracket



Frontal Clip



Bayonet

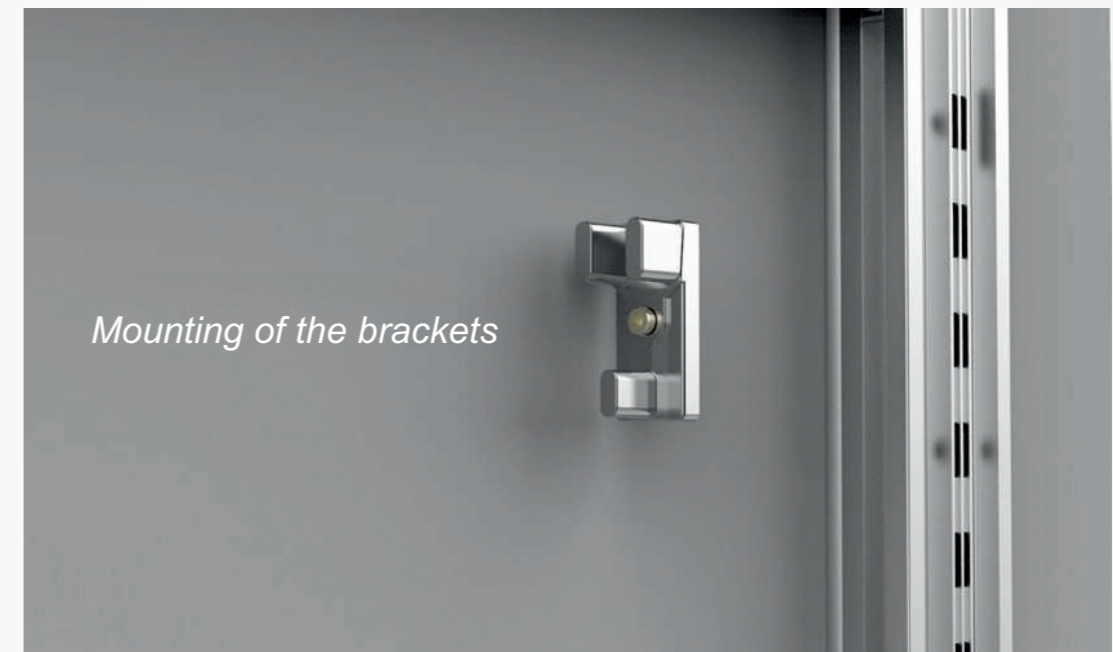

Fix the Bracket in Position



Fasten the Frontal clip by Screws

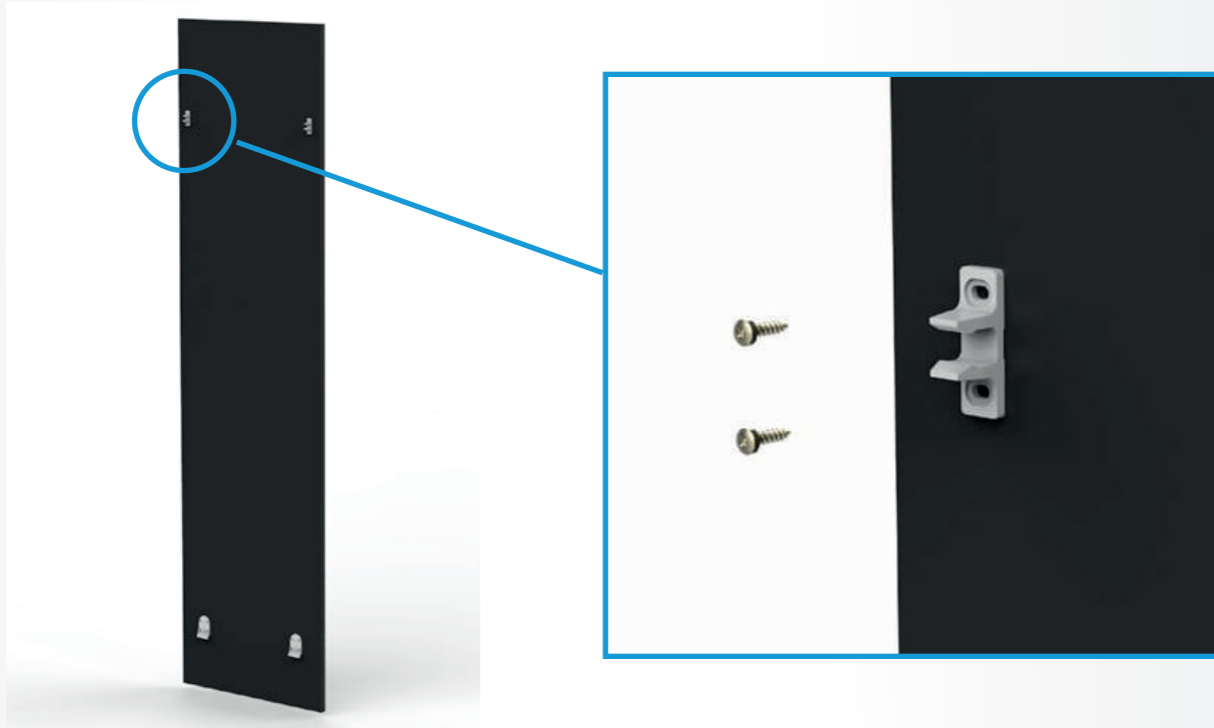

Fasten the Bayonet by Screws



Accessories for Wall Cladding System

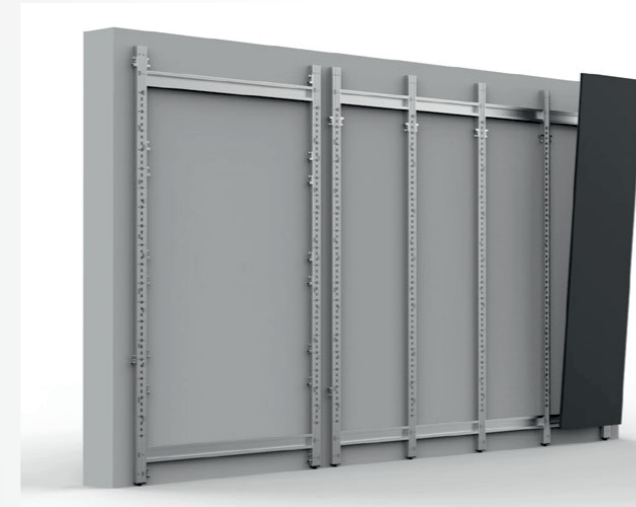

Place the shelf on the Lower Panel



Fasten the shelf to the Wall by Screws



Insert the Brackets to the Profile

Technical Data Sheet

Code: 011118.001.00.51

Vertical Profile 3 metres length pre drilled
Nat. Anodized

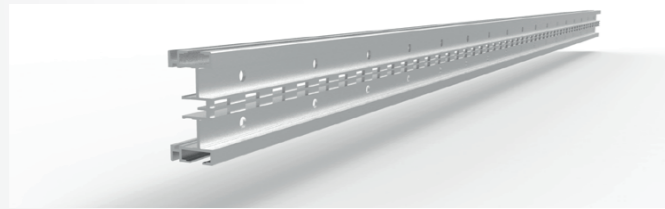

Code: 011117.L300.00

Horizontal profile 3 metres length raw finishes

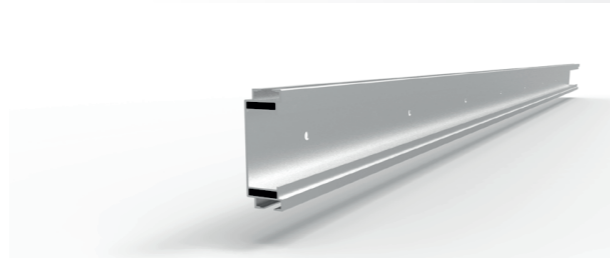

Code: 01CH252----3P

Corner joint for profile

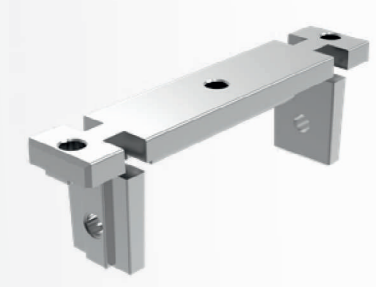

Mounting

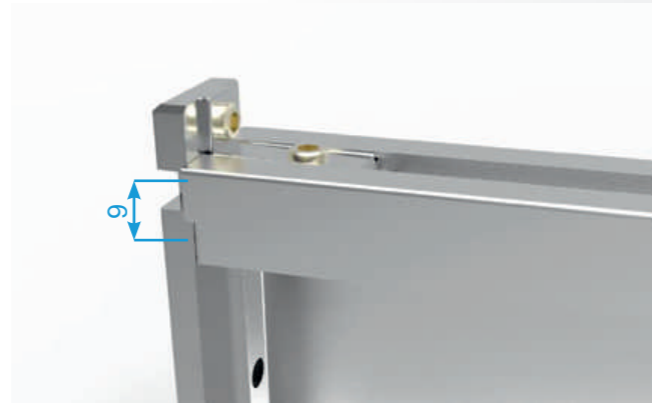
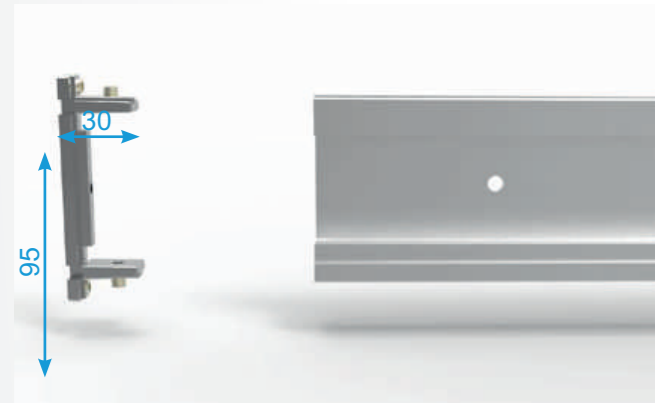

Code: 01CT330----0F

Plug with threaded hole for adjuster



Code: 000V463

Adjustable feet
Max stroke 20 mm



Code: 000V464

Wall Distance Adjuster
Max stroke 10 mm

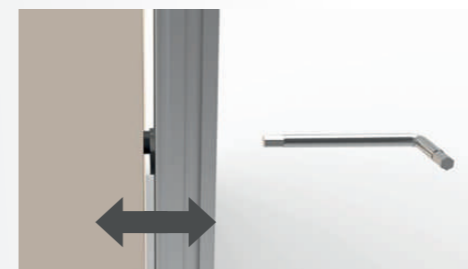

Code: 000H253

Bayonet for direct fixing to horizontal profile
Max weight 40 Kg cad
Max Spacing 900 mm



Code: 000H245

Fitlock Female for central fixing



Code: 000H243-S

Fitlock clip Soft



Drilling pattern

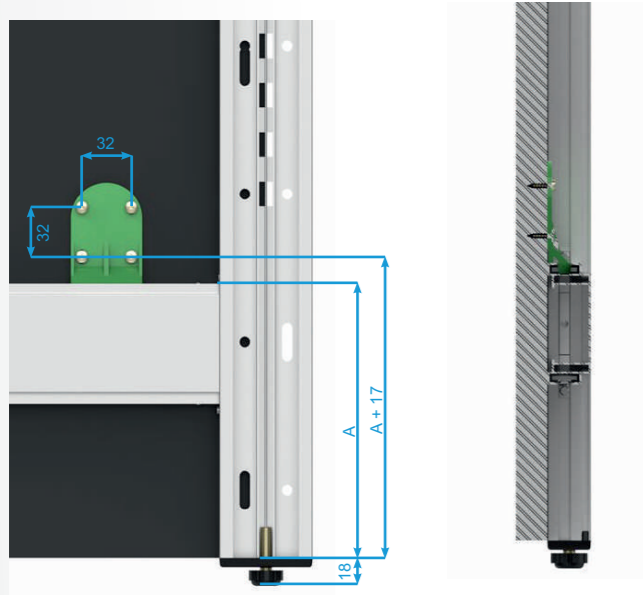

Pair max weight: **L=450mm 50 Kg**
L=600mm 50 Kg
Max Spacing 900 mm for shelves wider than 700mm, check the deformation of the panel.

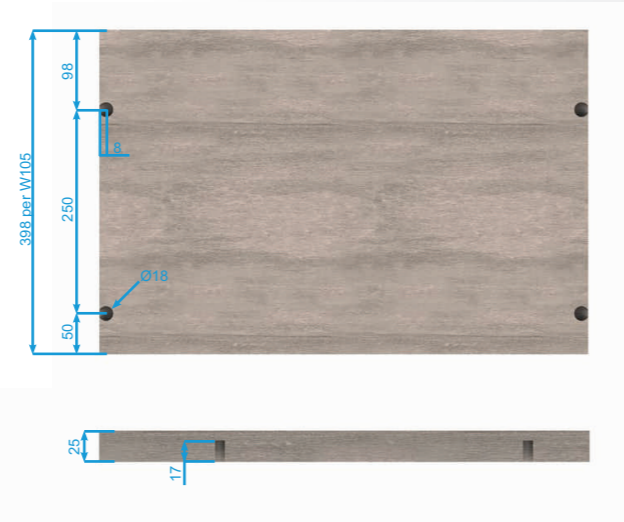

Code: 000W105- 07
 Pair of brackets with shelf supports
 (Lateral Side Support), painted



Code: 000W105-1 -07
 Central bracket w/shelf supports,
 painted



KITCHEN ACCESSORIES



NOVA PRO DRAWER SYSTEM

Drawer System Nova Pro Classic

Nova Pro Plain Drawer

Product Feature:

- *Fully synchronised slide technology without mid-way knock.
- *Excellent running characteristics.
- *Maximum stability.
- *Minimum drawer deflection.
- *Integrated height and side adjustment.
- *Drawer front can be fitted and removed without tools.
- *Bottom panel machining not required.
- *Width of bottom and black panel is the same.
- *Optimal use of storage space due to straight inside surfaces.
- *Narrow installation width.



Order Specification

NL	Weight
350mm	40kg
400mm	40kg
450mm	40kg
500mm	40kg
550mm	40kg
600mm	40kg

NL	Weight
500mm	70kg
550mm	70kg
600mm	70kg

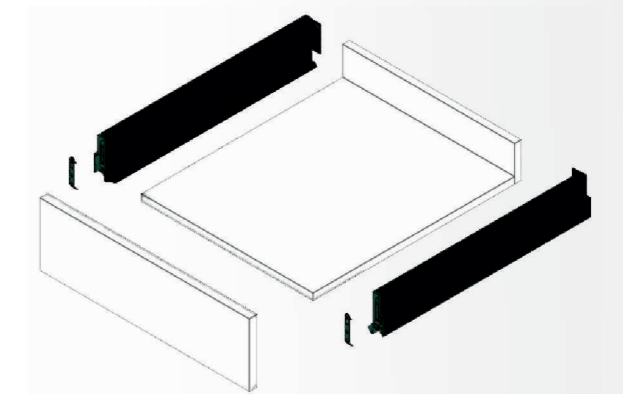

Technical Details

Installation Information

All dimensions in millimetres

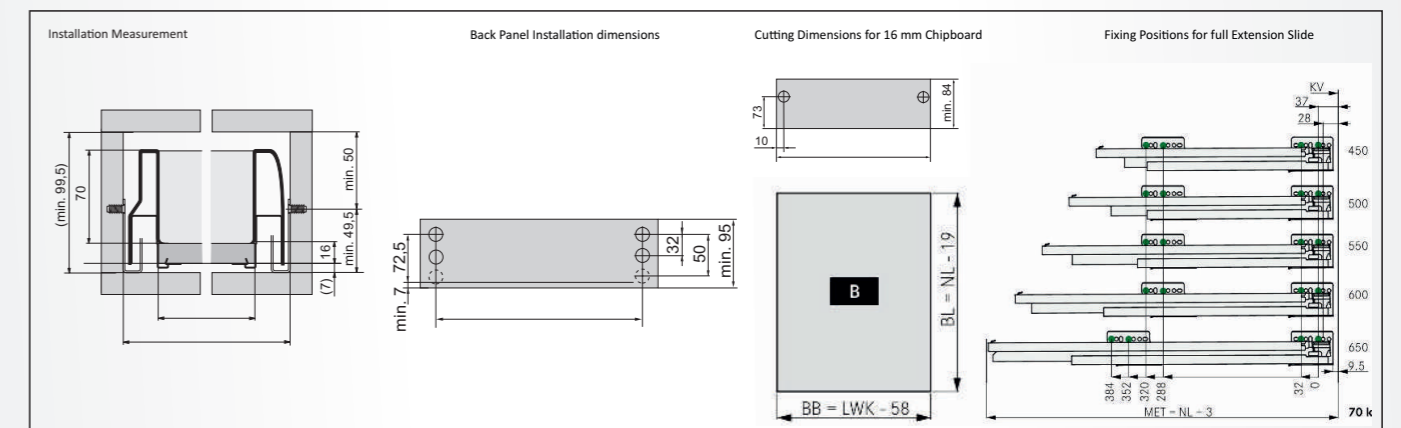

Nova Pro Railing Drawer

Product Feature:

- *Elegant rectangular railing system.
- *Fully synchronised slide technology without mid-way knock.
- *Excellent running characteristics.
- *Maximum stability.
- *Minimum drawer deflection.
- *Integrated height and side adjustment.
- *Tilt angle adjustment using railing.
- *Drawer front can be fitted and removed without tools.
- *Bottom panel machining not required.
- *Width of bottom and black panel is the same.



Order Specification

NL	Weight
350mm	40kg
400mm	40kg
450mm	40kg
500mm	40kg
550mm	40kg
600mm	40kg

NL	Weight
500mm	70kg
550mm	70kg
600mm	70kg

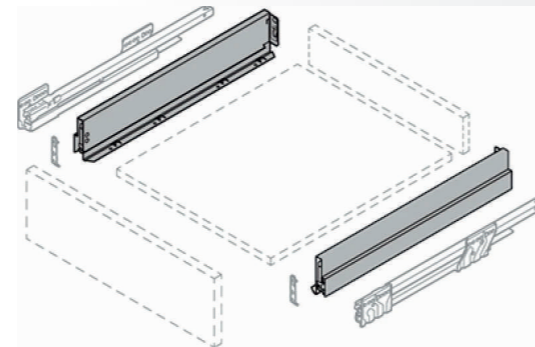

Technical Details

Installation Information

All dimensions in millimetres

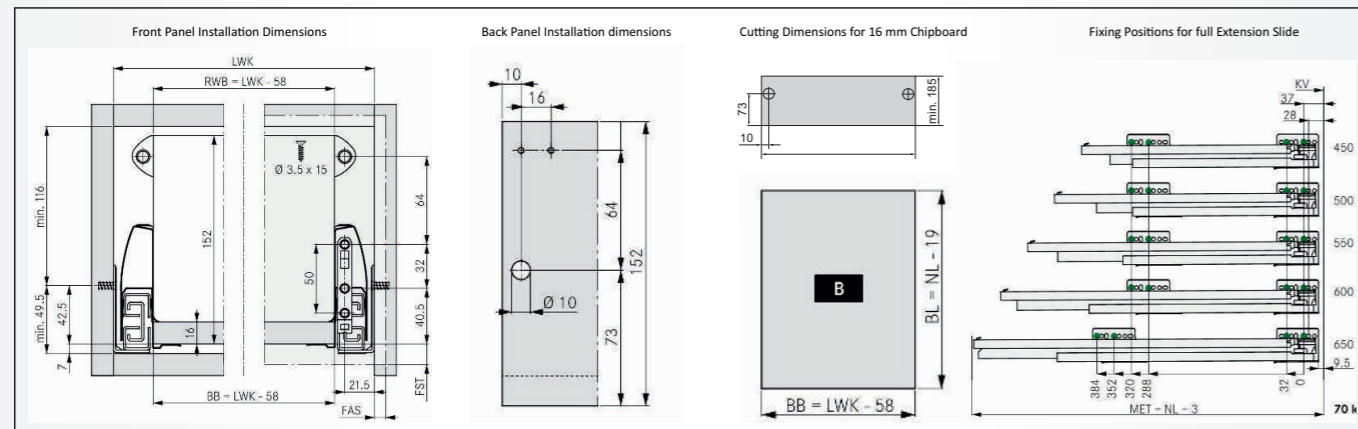

Nova Pro Railing Drawer with Front Support

Product Feature:

- *Additional fixing points for optimal stability with high fronts.
- *Fully synchronised slide technology without mid-way knock.
- *Excellent running characteristics.
- *Maximum stability.
- *Minimum drawer deflection.
- *Integrated height and side adjustment.
- *Tilt angle adjustment using railing.
- *Drawer front can be fitted and removed without tools.
- *Bottom panel machining not required.
- *Width of bottom and black panel is the same.



Order Specification

NL	Weight
500mm	40kg

NL	Weight
500mm	70kg

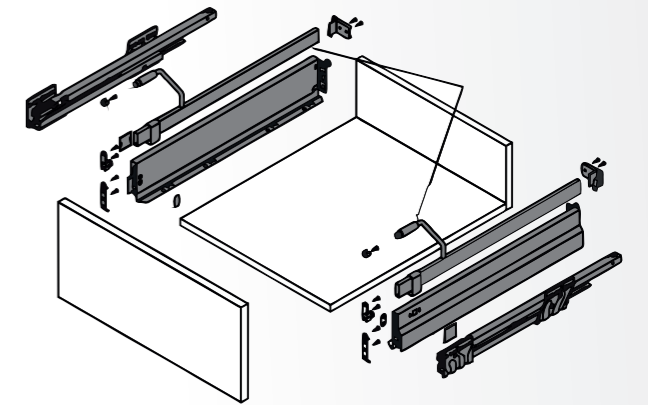

Technical Details

Installation Information

All dimensions in millimetres

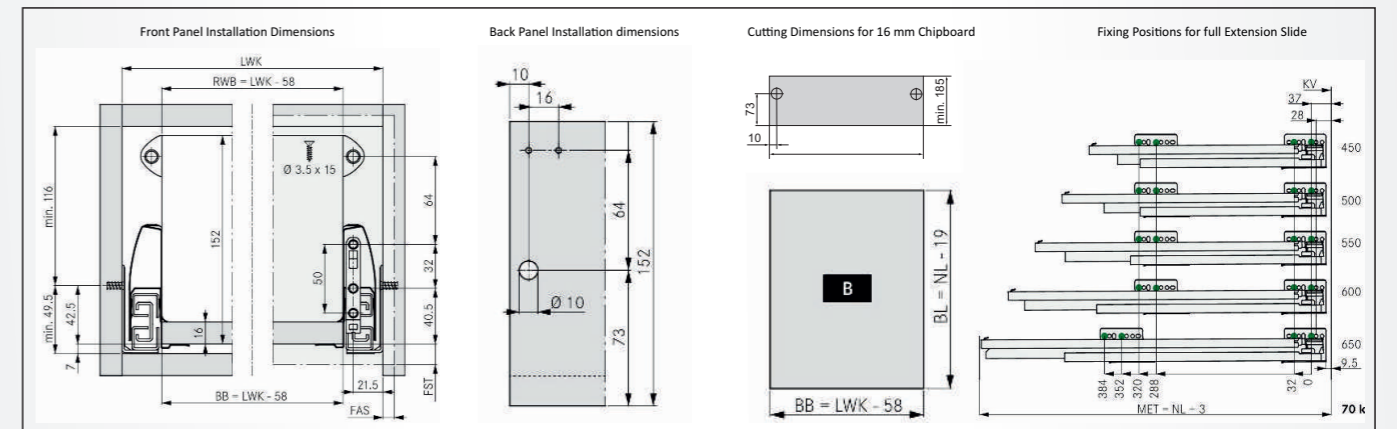

Nova Pro Inner Drawer

Product Feature:

- *Fully synchronised slide technology without mid-way knock.
- *Excellent running characteristics.
- *Maximum stability.
- *Minimum drawer deflection.
- *Front Panel can be fitted and removed without tools.
- *Bottom panel machining not required.
- *Width of Bottom and back panel is the same.
- *Optimal use of storage space due to straight inside surfaces.
- *Narrow construction width.



Order Specification

NL	Weight
450mm	40kg
500mm	40kg
550mm	40kg
600mm	40kg

NL	Weight
500mm	70kg
550mm	70kg
600mm	70kg

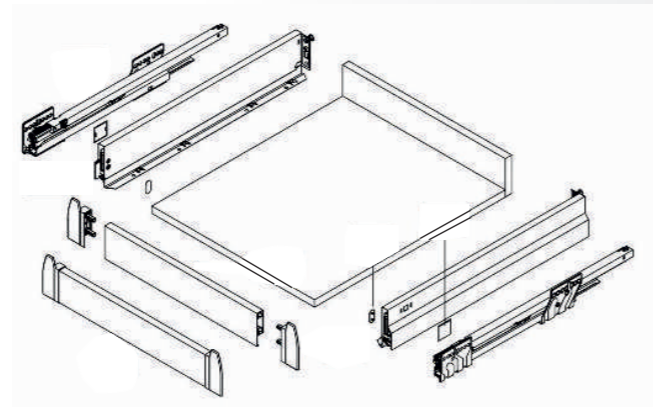

Technical Details

Installation Information

All dimensions in millimetres

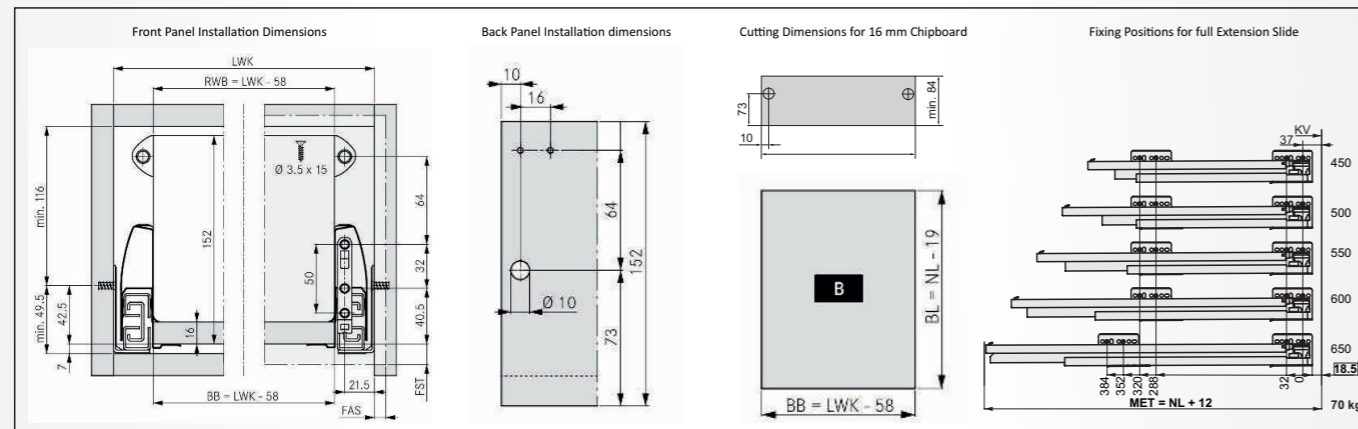

Nova Pro Inner Drawer with Square Railing

Product Feature:

- *Elegant rectangular railing system.
- *Fully synchronised slide technology without mid-way knock.
- *Excellent running characteristics.
- *Maximum stability.
- *Minimum drawer deflection.
- *Front Panel can be fitted and removed without tools.
- *Bottom panel machining not required.
- *Width of Bottom and back panel is the same.



Order Specification

NL	Weight
450mm	40kg
500mm	40kg
550mm	40kg
600mm	40kg

NL	Weight
500mm	70kg
550mm	70kg
600mm	70kg

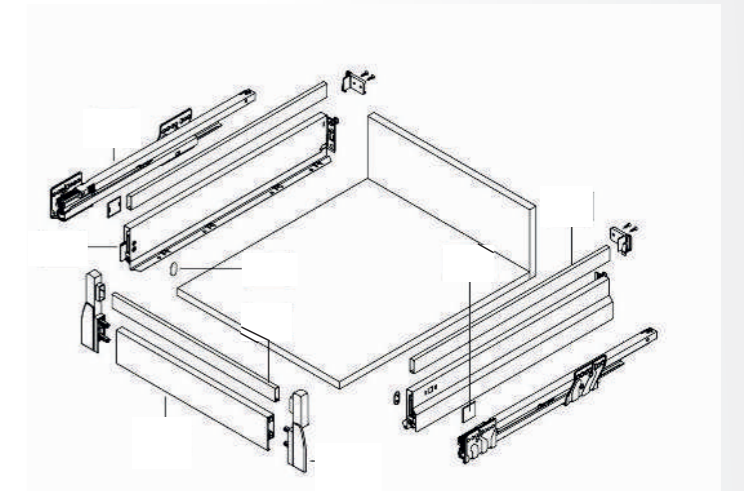

Technical Details

Installation Information

All dimensions in millimetres

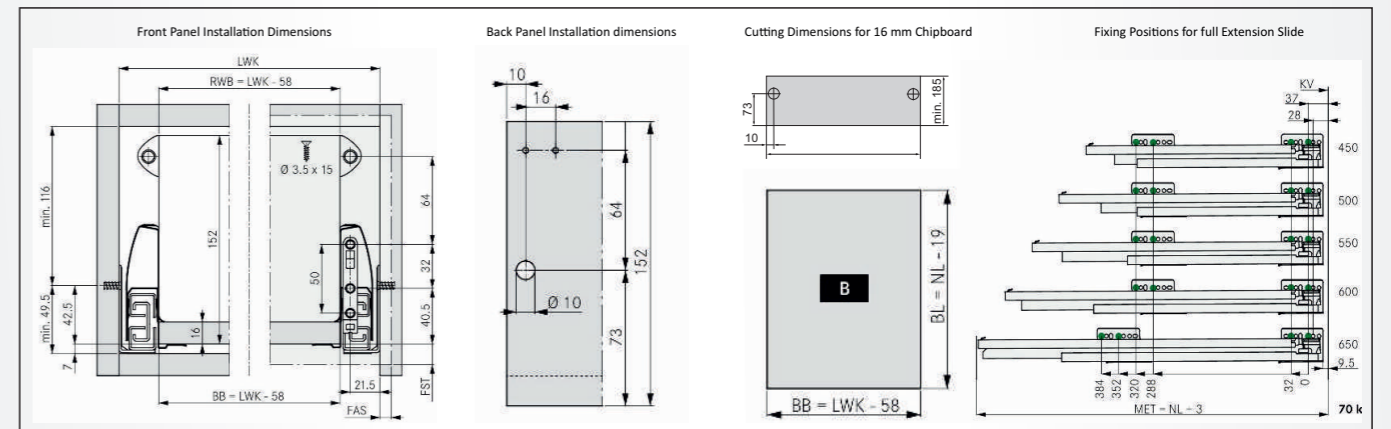

Nova Pro Inner Drawer Accessories (Profile & Bracket)

With this front you can turn your nova drawer into an interior pull-out. Suitable for nova sides with a height of 90mm.

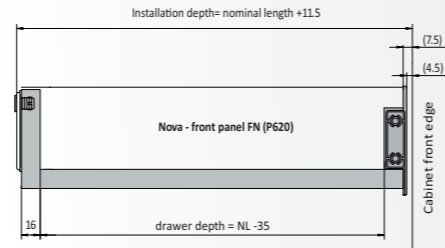

Nova Pro Inner Drawer with Railing (Profile, Front Rail & High Front Bracket)

With this front you can turn your nova drawer into an inset drawer with railing. Suitable for nova sides with a height of 90mm.

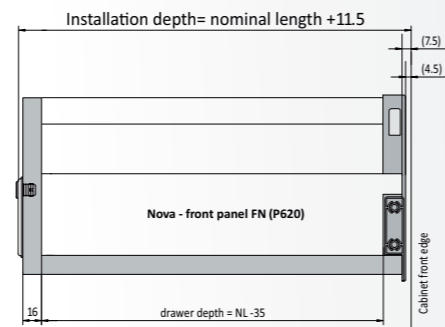
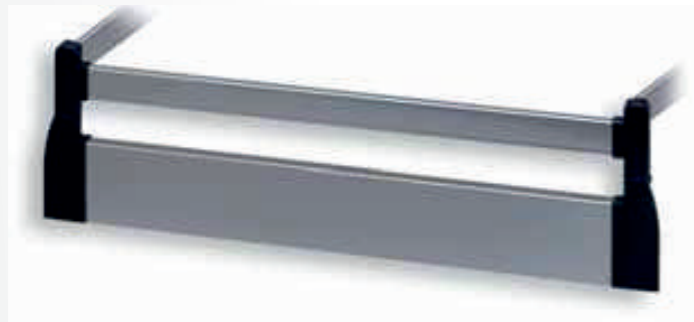

Grass Dynamoov Concealed Slides

Product Feature:

- *Full extension drawer synchronised.
- *30kg load capacity.
- *Soft-close damping system.
- *Step less self-locking of the drawer when placed on the slide.
- *Integrated height adjustment without tools +3.5mm.



Order Specification

NL	Weight
350mm	30kg
400mm	30kg
450mm	30kg
500mm	30kg
550mm	30kg

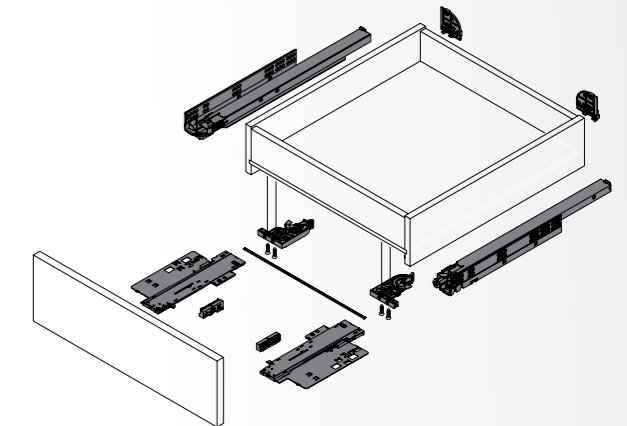

Technical Details

Installation Information

All dimensions in millimetres

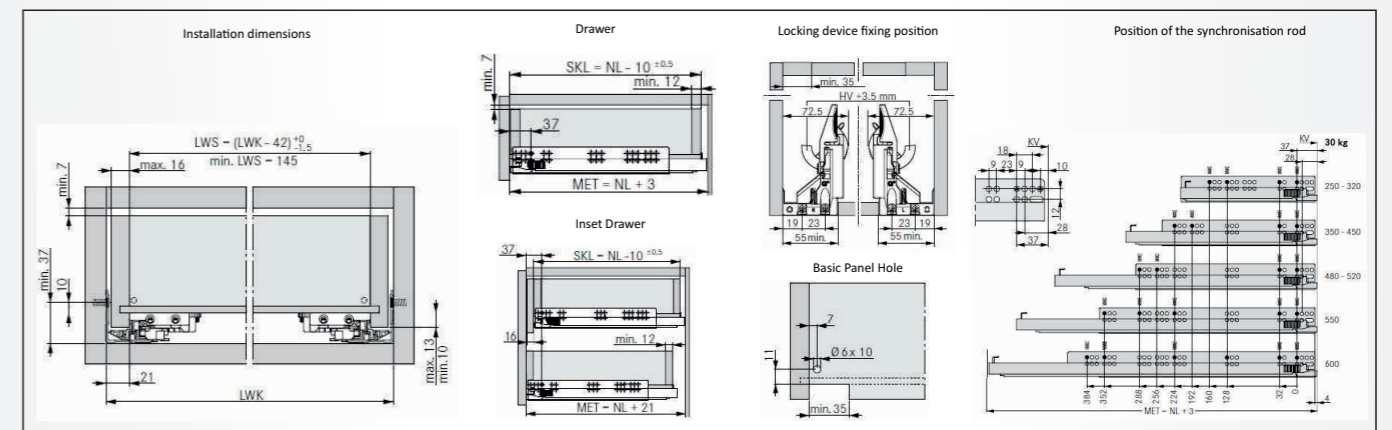

Drawer System Nova Pro Scala Stone

Nova Pro Scala Drawer H90

Product Feature:

- *The practical standard drawer for all applications.
- *Can be personalized with designer panels.
- *Integrated height and side adjustment.
- *Optimum use of space due to straight inside surfaces and low construction width.
- *Robust design and high level of stability.
- *Tool-free installation and removal of the front.
- *Width of bottom and back panel is the same.
- *Bottom panel machining not required.



Order Specification

NL	Weight
400mm	40kg
450mm	40kg
500mm	40kg
550mm	40kg
600mm	40kg

NL	Weight
500mm	70kg
550mm	70kg
600mm	70kg

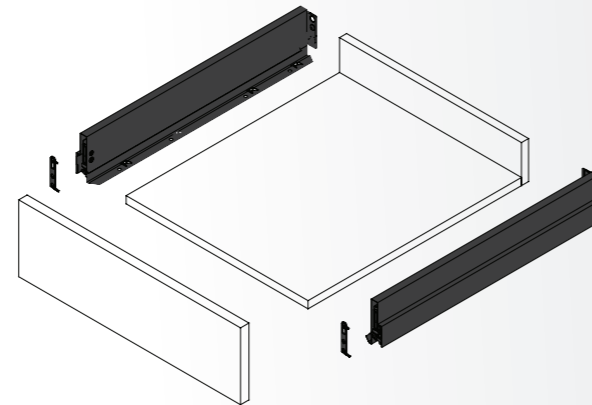

Technical Details

Installation Information

All dimensions in millimetres

S	16	18	19
EB	29	30	29
A	21.5	22.5	21.5

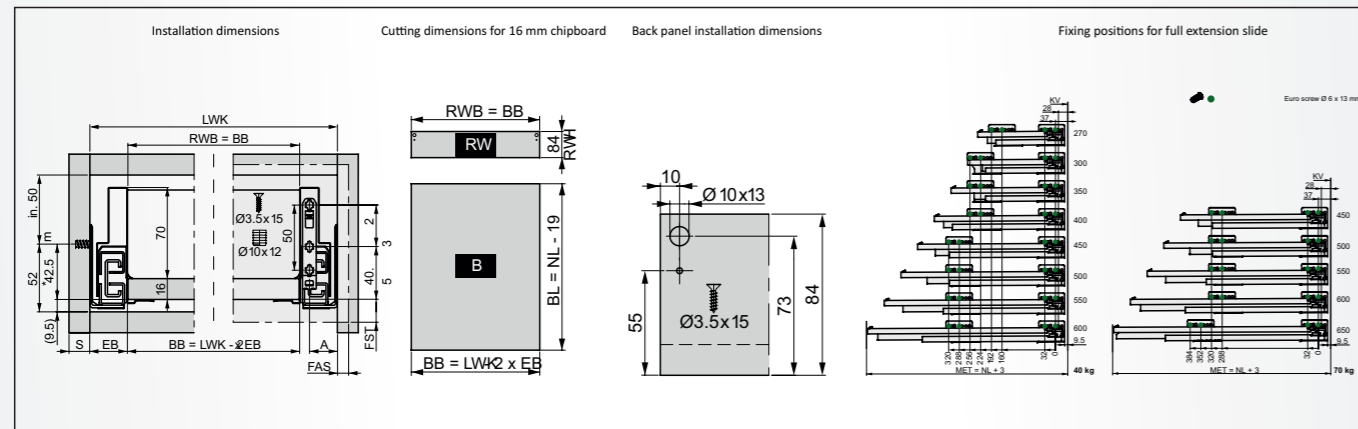

Nova Pro Scala Drawer H186

Product Feature:

- *Slim, closed drawer side.
- *High stability up to a front height of 780mm.
- *Can be personalized with designer panels.
- *Integrated height, side and tilt angle adjustment
- *Optimum use of space due to straight inside surfaces and low construction width.
- *Tool-free installation and removal of the front.
- *Width of bottom and back panel is the same.
- *Bottom panel machining not required.



Order Specification

NL	Weight
500mm	40kg

NL	Weight
500mm	70kg

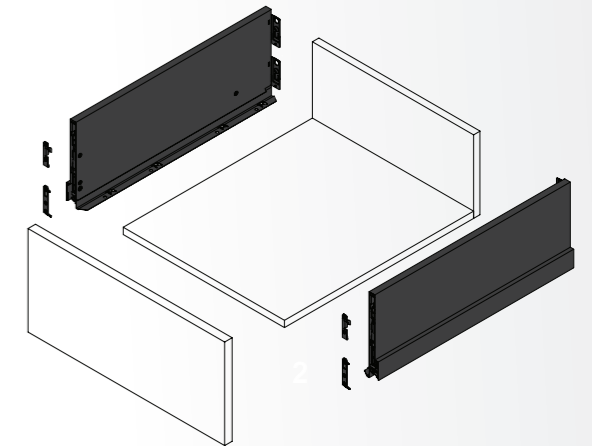

Technical Details

Installation Information

All dimensions in millimetres

S	16	18	19
EB	29	30	29
A	21.5	22.5	21.5

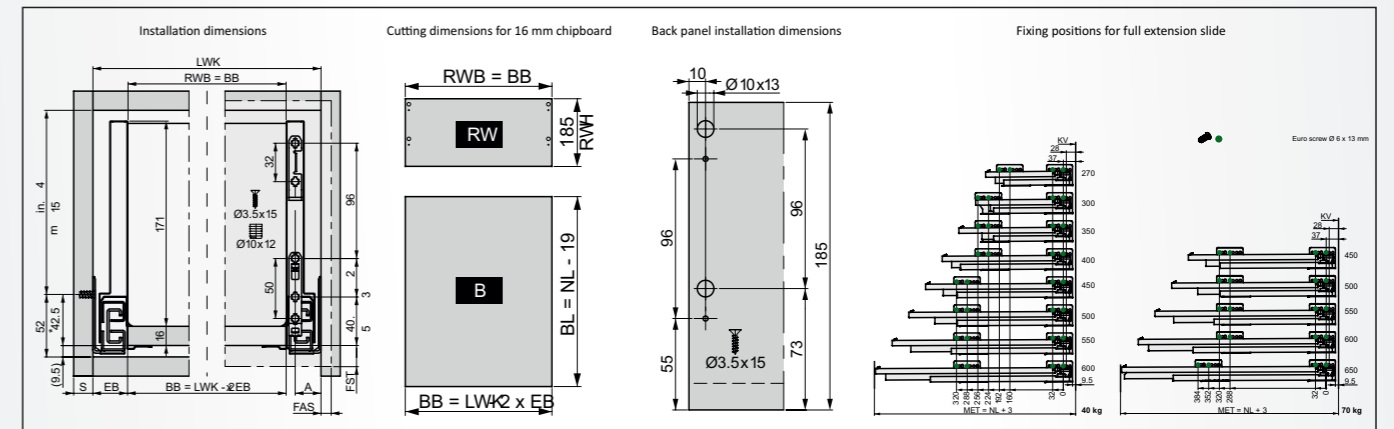

Nova Pro Scala Pot Drawer H90 with Rectangular Railing

Product Feature:

- *Snug-fitting rectangular railing.
- *Flush-fitting back panel adapter.
- *Minimum plastic parts.
- *Integrated height and side adjustment.
- *Tilt angle adjustment using railing.
- *Optimum use of space due to straight in side surfaces and low construction width.
- *Tool-free installation and removal of the front.
- *Width of bottom and back panel is the same.
- *Bottom panel machining not required.



Order Specification

NL	Weight
400mm	40kg
450mm	40kg
500mm	40kg
550mm	40kg
600mm	40kg

NL	Weight
500mm	70kg
550mm	70kg
600mm	70kg

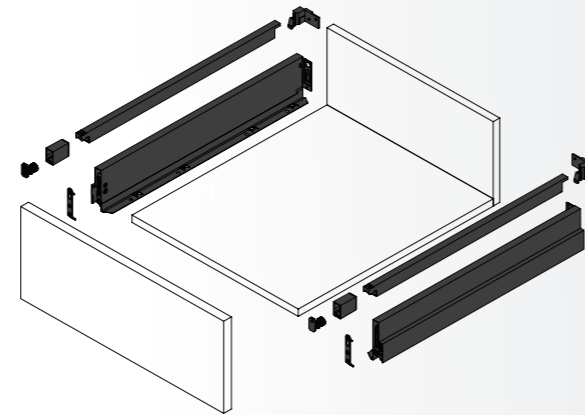

Technical Details

Installation Information

All dimensions in millimetres

S	16	18	19
EB	29	30	29
A	21.5	22.5	21.5

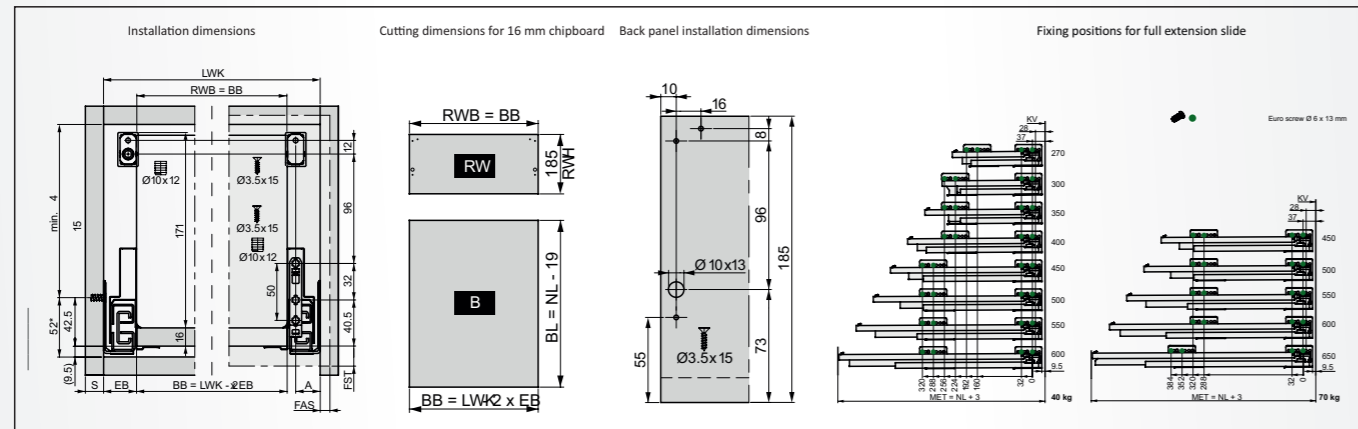

Nova Pro Scala Crystal Plus H186

Product Feature:

- *No processing of the slide-in elements necessary.
- *Patented clip technology makes it easy to slide the elements.
- *No additional cover caps.
- *High level of stability, also without front and slide-in elements.
- *Integrated height, side and tilt angle adjustment.
- *Optimum use of space due to straight inside surfaces and low construction width.
- *Tool-free installation and removal of the front.



Order Specification

NL	Weight
500mm	40kg
550mm	40kg

NL	Weight
500mm	70kg
550mm	70kg

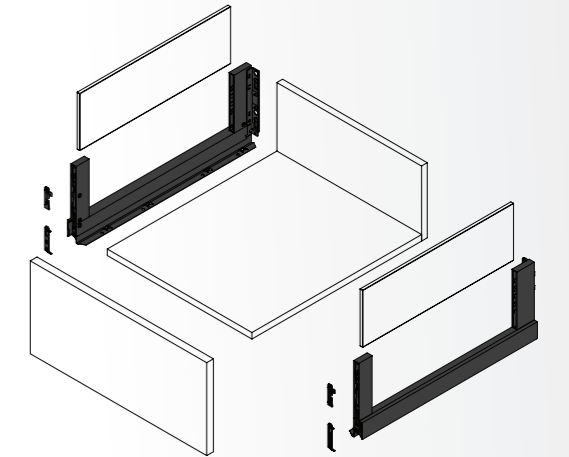

Technical Details

Installation Information

All dimensions in millimetres

S	16	18	19
EB	29	30	29
A	21.5	22.5	21.5

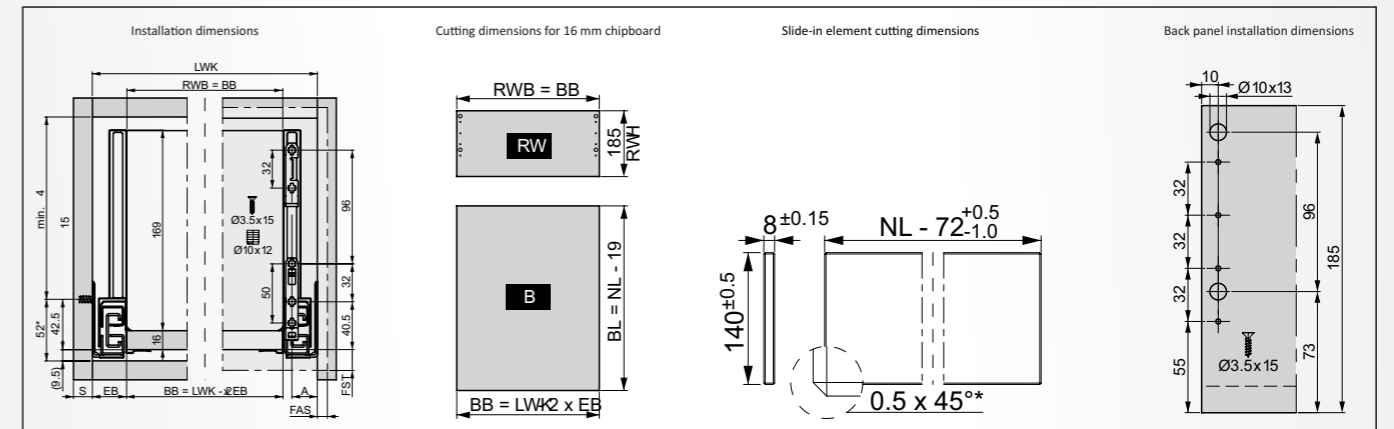

Nova Pro Scala Inset Drawer H90

Product Feature:

- *Colour-coordinated aluminium front panel profile.
- *High-quality design with smooth inside and outside surfaces.
- *Same dimensions as for standard drawers (inside depth).
- *Also for cutting to length.



Order Specification

NL	Weight
400mm	40kg
450mm	40kg
500mm	40kg
550mm	40kg
600mm	40kg

NL	Weight
500mm	70kg
550mm	70kg
600mm	70kg

Technical Details

Installation Information

All dimensions in millimetres

S	16	18	19
EB	29	30	29
A	21.5	22.5	21.5

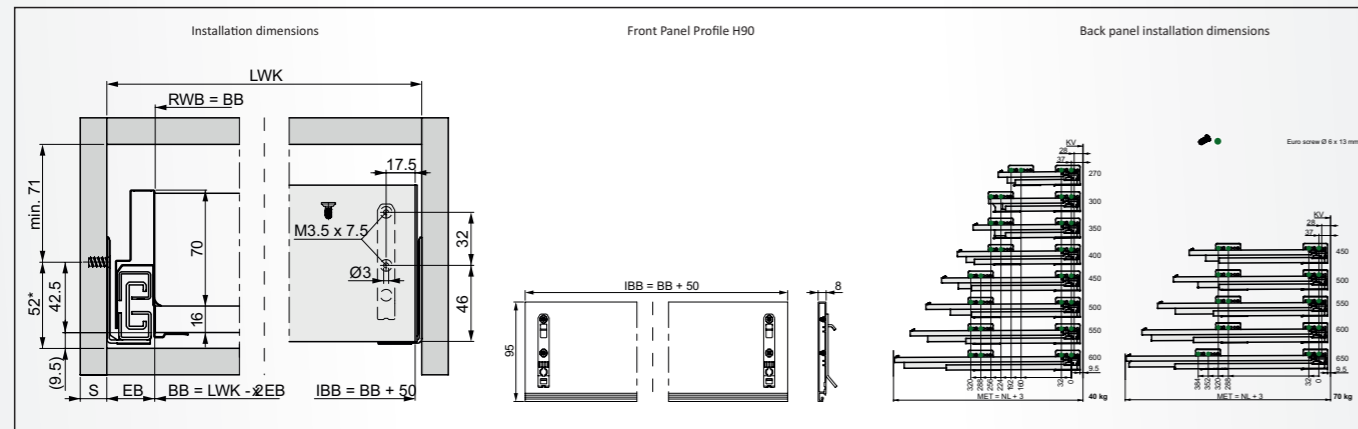

Nova Pro Scala Inset Drawer H90 with Rectangular Railing

Product Feature:

- *Colour co-ordinated aluminium front panel profile.
- *High-quality design with smooth inside and outside surfaces.
- *Same dimensions as for standard drawers (inside depth).
- *Also for cutting to length.



Order Specification

NL	Weight
400mm	40kg
450mm	40kg
500mm	40kg
550mm	40kg
600mm	40kg

NL	Weight
500mm	70kg
550mm	70kg
600mm	70kg

Technical Details

Installation Information

All dimensions in millimetres

S	16	18	19
EB	29	30	29
A	21.5	22.5	21.5

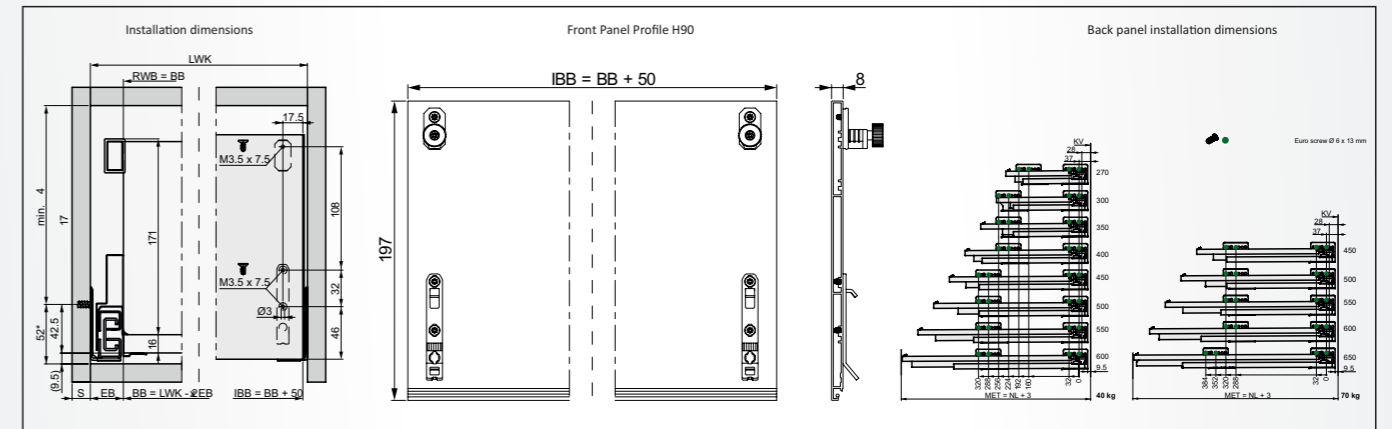

Nova Pro Scala Inset Drawer H186 Crystal Plus

Product Feature:

- *Colour co-ordinated aluminium front panel profile
- *High-quality design with smooth inside and outside surfaces
- *Same dimensions as for standard drawers (inside depth)
- *Also for cutting to length



Order Specification

NL	Weight
500mm	40kg
550mm	40kg

NL	Weight
500mm	70kg
550mm	70kg

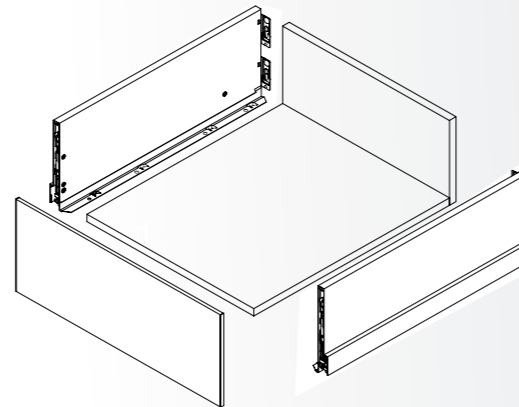

Technical Details

Installation Information

All dimensions in millimetres

S	16	18	19
EB	29	30	29
A	21.5	22.5	21.5

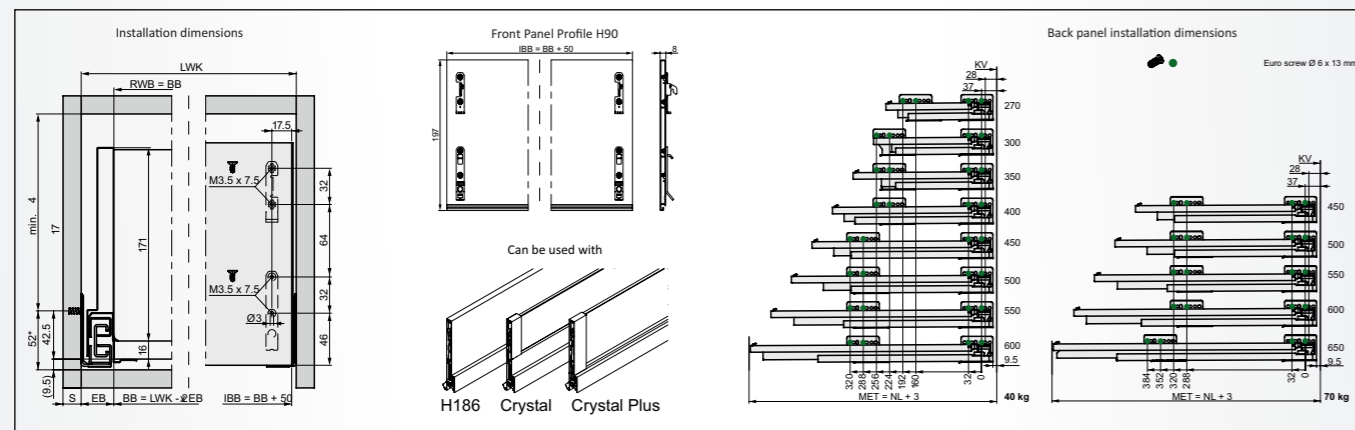

Nova Pro Scala Inset Drawer Accessories

Order Information

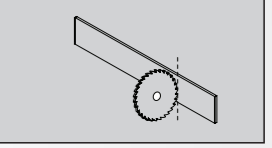
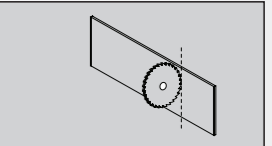
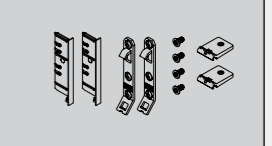
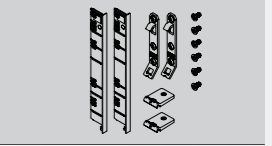
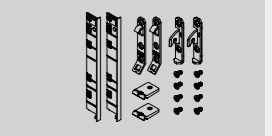
- F8 inset panel for inset drawer H90**
Single item: for cutting to length incl. cardboard drilling template. 
- F8 inset panel for inset drawer H186, rectangular railing, Crystal and Crystal Plus**
Single item: for cutting to length incl. cardboard drilling template. 
- Accessories F8 inset panel for inset drawer H90**
Set: F8 cover cap (2x), installation hook (2x), special screws (4x) and front-bottom connector (2x). 
- Accessories F8 inset panel for inset drawer H90 with rectangular railing**
Set: F8 cover cap (2x), installation hook (2x), special screws (6x) and front-bottom connector (2x). 
- Accessories F8 inset panel for inset drawer H186, Crystal and Crystal Plus**
Set: F8 cover cap (2x), installation hook (2x), front clip (2x), special screws (8x) and front-bottom connector (2x). 

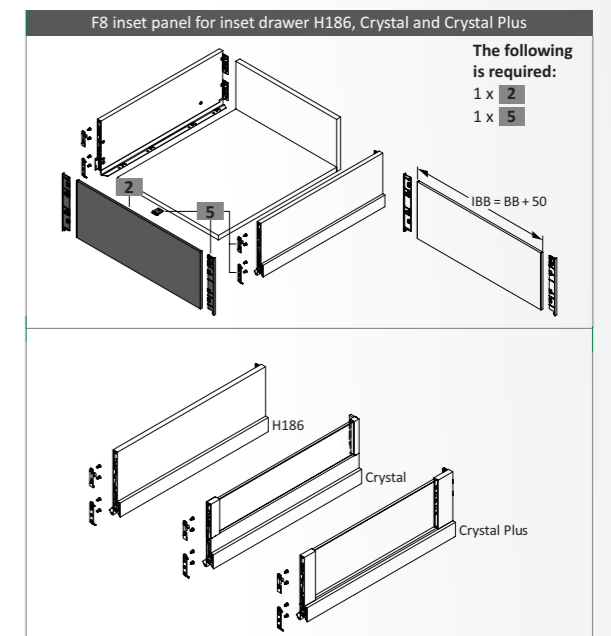
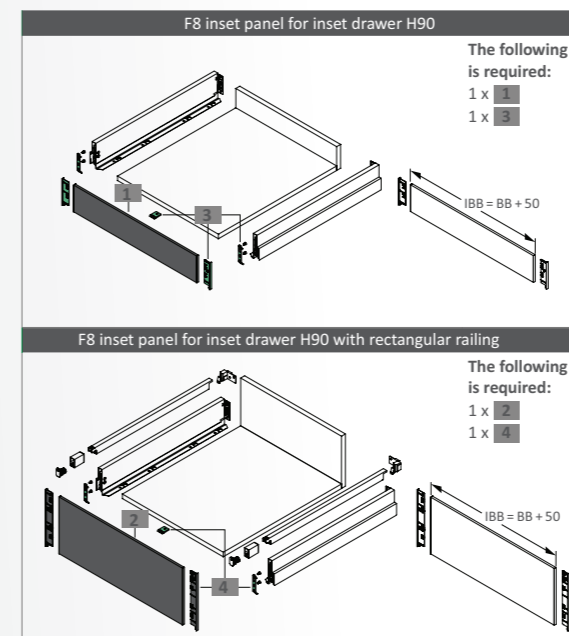

Drawer System

Drawer Internal Accessories: Drawer Internal Accessories Cutlery Tray-Graphite & Grey



Product Feature:

*Certified for food contact, Resistant to scratches.

Available in 400mm, 450mm, 600mm & 900mm Widths of cabinets and depth only 500mm of cabinets.

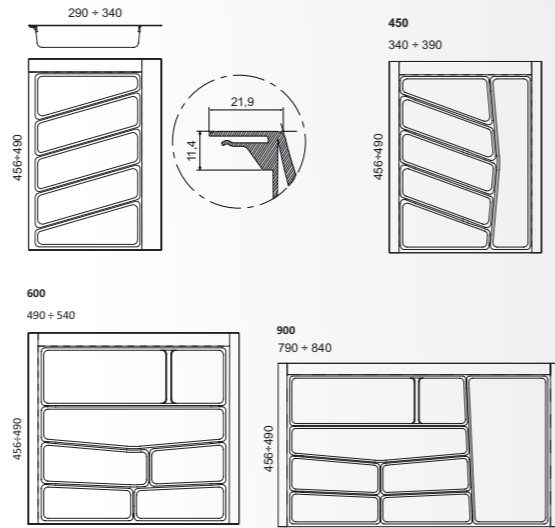

Article Number: Graphite

Code	Drawer Size	Width	Depth
32/76.R40	400	290-340mm	460-490mm
32/76.R45	450	340-390mm	460-490mm
32/76.R60	600	490-540mm	460-490mm
32/76.R90	900	790-840mm	460-490mm

Article Number: Grey

Code	Drawer Size	Width	Depth
32/78.N45	450	345-390mm	460-490mm
32/78.N60	600	495-540mm	460-490mm
32/78.N90	900	800-840mm	460-490mm

Application : Food items and Kitchen utensils can be stored easily, This is portable modular kitchen PVC cutlery tray.

Antislip Matt

Finishes: Grey & Graphite

Size: 480mm x 30 Meters

Article Number :

Code	Depth	Thickness	Roll Length
34/R1.B	480mm	1.2mm	30mtr

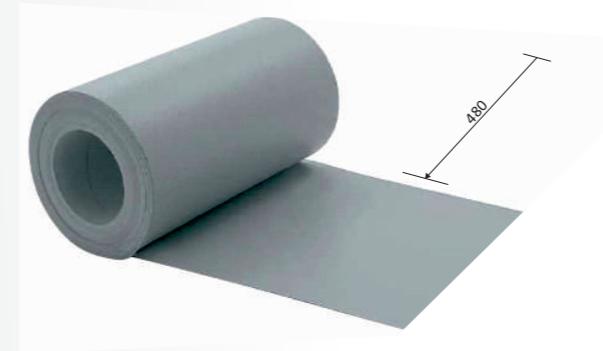

Plate Rack

Article No: ABS615PG

Dimension: W: 175mm x D: 210mm x H: 87mm

Product Feature:

*Plate rack as a support on the Chrome Finish glass rack.

*ABS standard plastic grey finish.

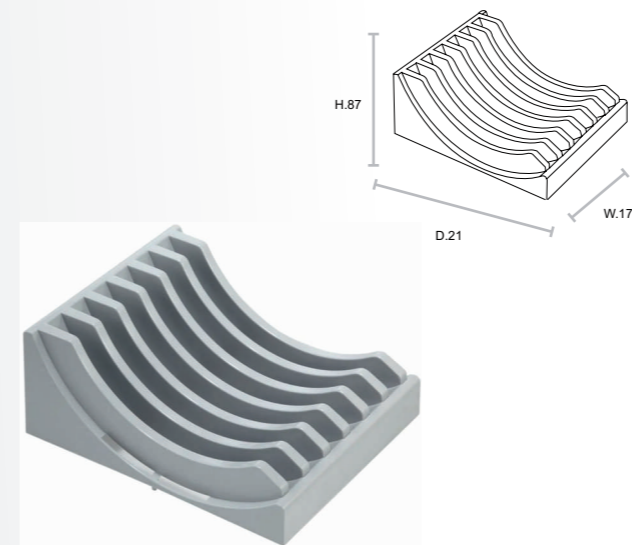

New Antislip Matt

Finishes: Light Brown Matt

Size: 1440mm x 30 Meters

Article Number :

Depth	Roll Length
1440mm	30mtr

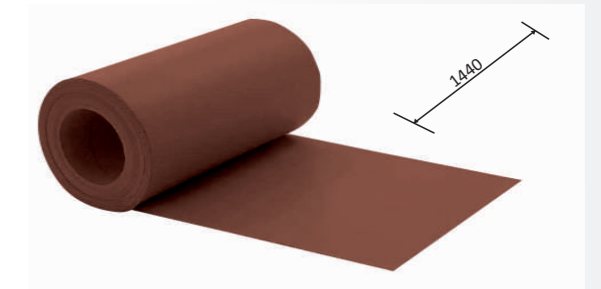

Saucer Rack

Article No: ABS615PP

Dimension: W: 105mm x D: 210mm x H: 30mm

Product Feature:

*Small rack as a support on the Chrome Finish glass rack.

*ABS standard plastic grey finish.

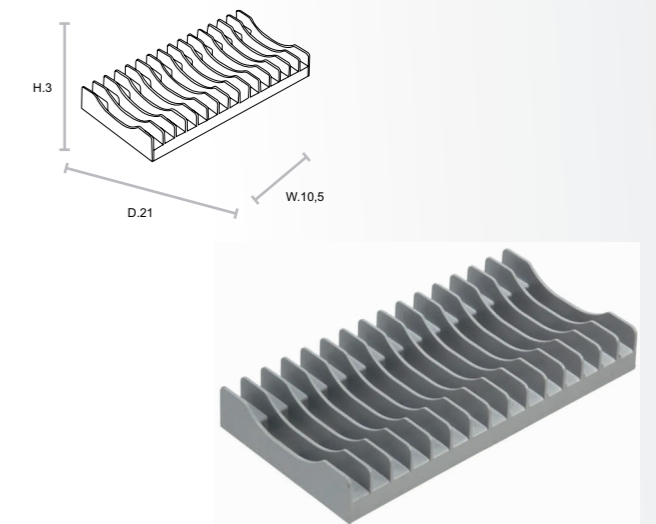

Syphon Flex

Product Feature:

- *Volpato syphon flex to suit undersink drawer.
- *Suit 16mm base in finish grey.

Article Number:

Code	Finish	Thickness	Length
35/10.1660	Grey	16mm	680mm

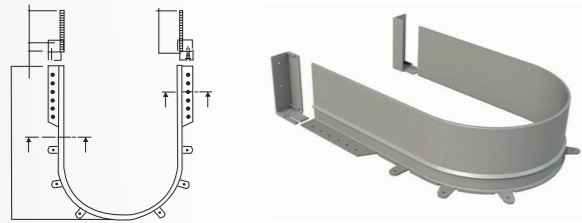

Sink Base

Product Feature:

- *This product is able to resist to humidity and deterives.
- *Maintaining unaltered the structure of the furniture.

Available in cabinet width 600mm & 900mm with Grey finish.

Article Number:

Ar. Code	Finish	Size	Width	Internal Size
41/10060	Grey	18mm	600mm	563mm
41/10080	Grey	18mm	800mm	763mm
41/10090	Grey	18mm	900mm	863mm

Application: It is used in sink cabinet.

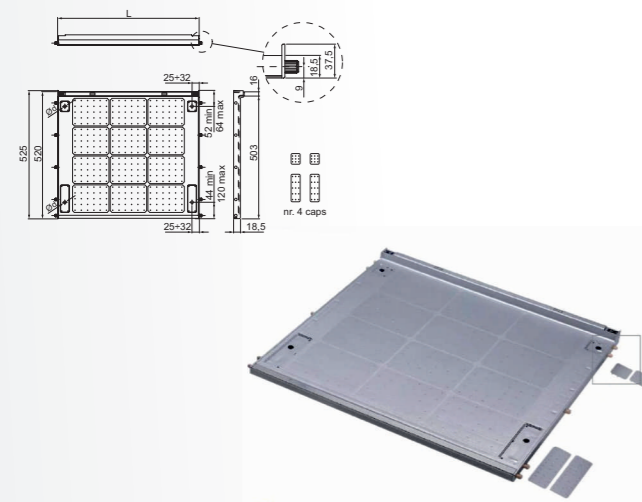

Pro Cabinet

Product Feature:

- *Moisture resistant, protects furniture from getting wet.
- *Easy to clean it.

Available in cabinet width 600mm, 800mm, 900mm & 1200mm with Grey finish.

Article Number:

Code	Finish	Thickness	Length
43.10.060	Grey	18mm	600mm
43.10.080	Grey	18mm	800mm
43.10.090	Grey	18mm	900mm
43.10.1200	Grey	18mm	1200mm

Application: It is designed to protect the Kitchen or Bathroom cabinet from humidity and dirt.

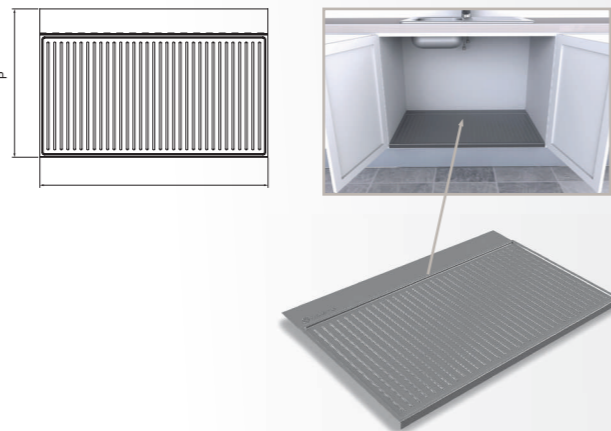

Ring Waste Bin

Article No: PP602/1

Dimension: W: 270mm x D: 270mm x H: 320mm

Product Feature:

- *Swing out wastbin with auto lid for cabinet door.
- *Available in grey finish only.
- *Automatic opening with 10ltr. capacity.
- *Easy to assemble.
- *Can be mounted the right or left side.

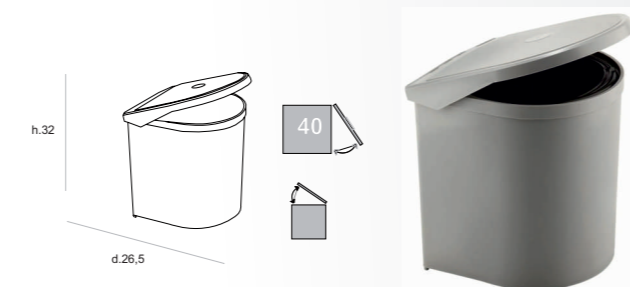

ECOFIL Waste Bin

Article No: PF0134A2

Dimension: W: 230mm x D: 450mm x H: 405mm

Product Feature:

- *Steel ball bearing sliders with a full extension.
- *Strong and durable.
- *Versatile and space-saving.
- *Available in grey finish with 24ltr. capacity.
- *Easy installation with only 4 screws.
- *Easy to clean.



Swing Wastebin: 1 Bucket & 2 Bucket:

Article No: PBDAASM28 & PBDBASG28

Dimension:
 1. One Bucket Wastebin: W: 260mm x D: 250mm x H: 290mm
 2. Two Bucket Wastebin: W: 420mm x D: 330mm x H: 290mm

Product Feature:

- *Robust swivel bucket made of powder painted steel.
- *Automatic extraction connected to the opening of the cabinet's door possibility of mounting all of the cover box series buckets with capacities from 6 to 24 liters.
- *Automatic lid opening version also available.
- *Possibility of mounting two overlapping structures.
- *One and Two buckets version available.
- *Easy to clean.

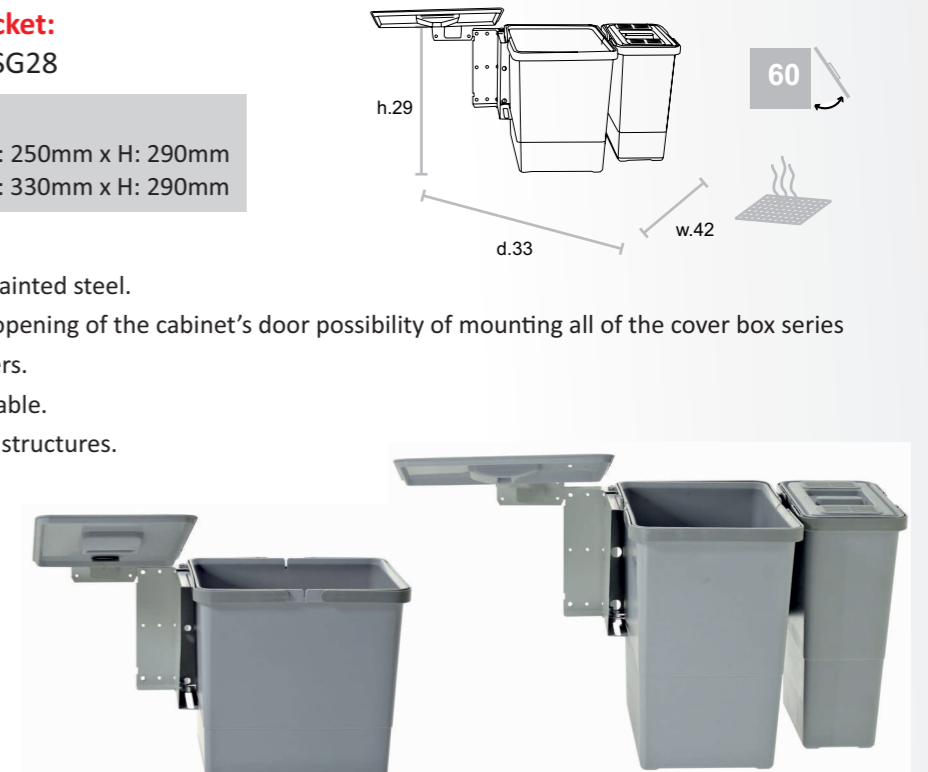

Metropolis 90cm

Article No: PTC22090501F

Dimension: W: 810-830mm x D: 460-490mm x H: 220mm

Product Feature:

- *Supplied with a flexible seal to compensate for any differences in terms of size, fully blocking the tray.
- *The dividers can be re-positioned to ensure flexibility.
- *All the bins have with a bucket with a lid.
- *Available in Grey Finish with 36ltr. capacity.
- *The plastic model has a number of modular trays supplied in kit form.

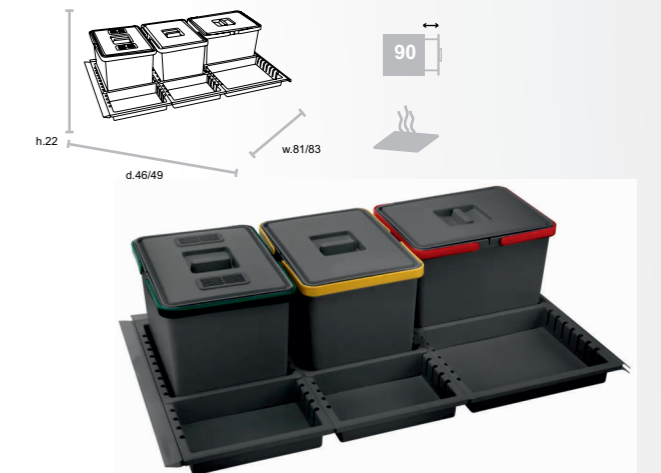

Fridge Base Wind

Product Feature:

Wind Ventilation Base, resistant to Humidity.

Available for cabinet width 600mm.

Article Number:

Ar. Code	Finish	Size	Thickness
31/77B0B	Black	600mm	18mm

Application: It is made to resist the weight of any built in fridge.

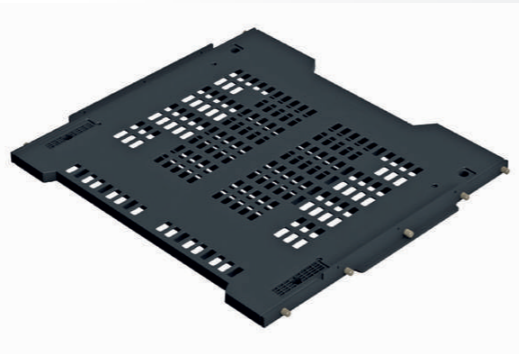
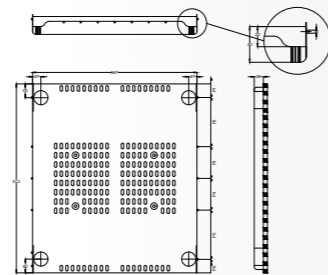

Ventilation Grill

Product Feature:

Ventilation grill is designed for supply and extraction of air in furniture.

Available in black and white colour & Two different types i.e. Round & Rectangular.

Article Number:

Ar. Code	Finish
21/90.449	Rectangle Black
21/90.449	Rectangle Alu Grey
21/90.443	Round Black
21/90.443	Round Alu Grey

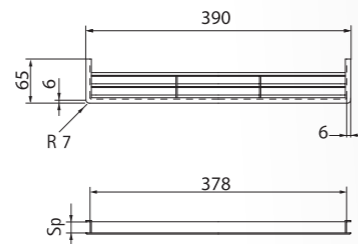
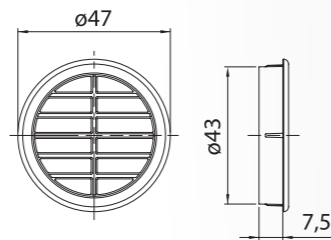

Application: It is useful for where ventilation is required like in cabinets and drawers, especially for gas cylinders, wardrobes etc.

BASE & TALL PULLOUT UNITS



BASE & TALL PULLOUTS

Base Pull Out-150mm

Side Base Pull Out Unit

Two-tier side-mounted base pull-out unit, melamine bottom and aluminium solid rail, D 468mm with full extension slides and soft close. Ultra easy and quick releasing system of the slides with three-way adjustable door brackets.

CODE	W	D	H
ELQGM152SXU	150	468	531

Technical Details

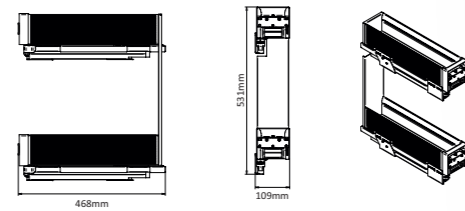

Base Pull Out-300mm

Base Pull Out Unit

Two-tier base pull-out unit, melamine bottom and aluminium solid rail, D 471mm, with full extension slides and soft close. Ultra easy and quick releasing system of the slides with three-way adjustable door brackets.

CODE	W	D	H
EGTGM30B2U	300	471	483

Technical Details

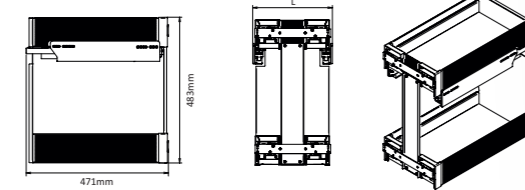

BASE & TALL PULLOUTS

Larder Pull Out-300 & 450mm with 5 Basket

Column Frame with Roller Guides

Kit composed of height adjustable frame kit and full extension runner with soft close (load capacity 120 kg).

CODE	W	D	H
CE1905GCFTM	300	487	1760-2200
CE1905GCFTM	450	487	1760-2200



Column Basket

Larder unit basket with melamine bottom & aluminium solid rail. The basket can be easily installed on the frame. The basket is hooked and locked in the holes of the frame through an easy click.

CODE	W	D	H
CC30U	300	485	100
CC45U	450	485	100



Door Bracket and Fixing Adjustment

Kit consisting of: 1 door mounting bracket and mounting hardware. Fast application to frame internal holes.

CODE	W	D	H
CK130N	300	40	45
CK145N	450	40	45



Righting for Column Sides

Linking kit that allows to straighten the size of the cabinet. Suitable for all cabinet doors. Suitable also for full extension runners.

CODE	W	D	H
KRCE30	300	52	85
KRCE450	450	52	85



Maxi Pull Out-600mm with 5 Basket

Maxi Column Frame

Pull-out frame for maxi-larder unit. Opening door to 120°. Reversible: right = left.

CODE	W	D	H
CEM60S/17	600	488	1845



Technical Details

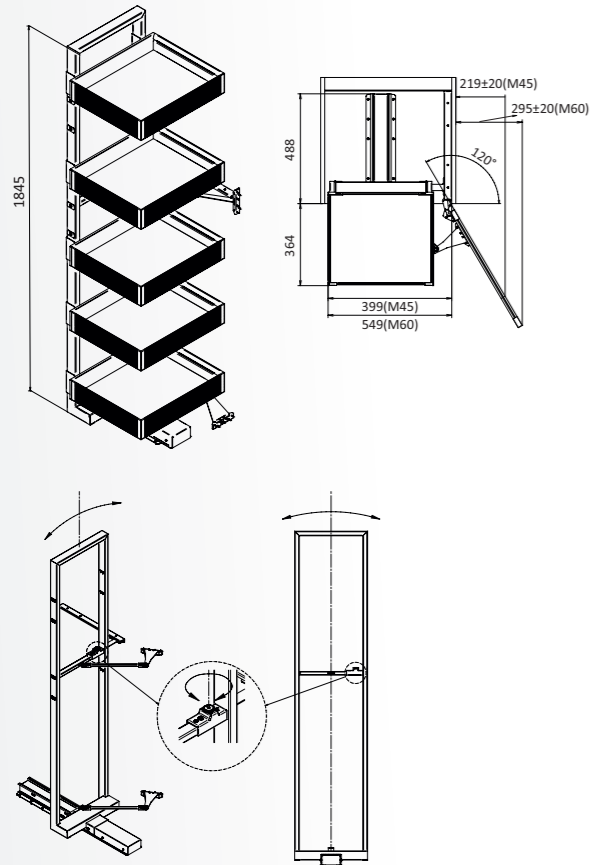

Maxi Column Basket

Maxi larder unit basket with melamine bottom and aluminium solid rail. Basket can be easily installed on the frame.

CODE	W	D	H
CEM60CM1U	600	407	117



Four Side Drawer-600mm

Four Side Drawer

H 96 four-side drawer, melamine bottom and aluminium solid rail, D 468mm, with full extension slides and soft close.

CODE	W	D	H
CCTGM60U	600	468	96



Technical Details

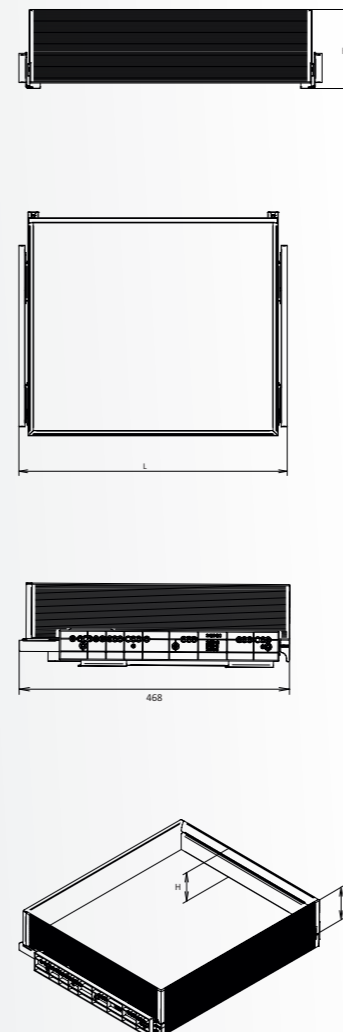

Swing Out Pantry-600mm with 5 Basket

Pull Out Inside Baskets

2 H 96 inner baskets with melamine bottom & aluminium solid rail. (For mechanism H 1675 recommended n.3 kits with 2 baskets.)

CODE	W	D	H
EDCI60M2U	600	265	96



Pull Out Door Baskets

2 H 96 door baskets with melamine bottom & aluminium solid rail. (For mechanism H 1675 recommended n.3 kits with 2 baskets.)

CODE	W	D	H
EDCP60M2U	600	150	96



Double Pull Out Frame

Swing out pantry unit mechanism H 1675mm height. 120° door opening. Load capacity 80kg. reversible.

CODE	M	W	D	H
EDS1706/19	60	600	489	1675

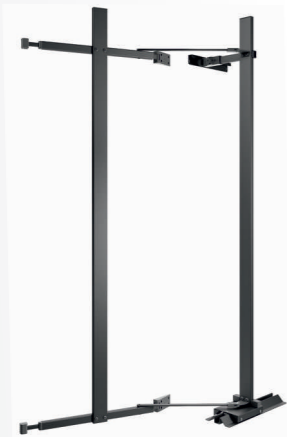

Technical Details

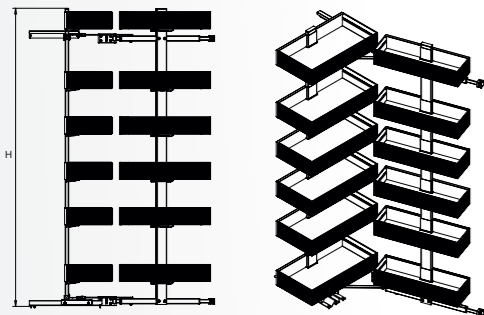

Corner Solution

Blind Corner

Fly Moon Base Mechanism

Fly Moon angular mechanism 3.0 for corner base with door 45. Adjustable in height from 655 to 705 mm, prepared for n.2 tiers. With soft close 45.

Fly Moon Shelves

Kit made up of n.2 pull-out shelves for Fly Moon mechanism, base and column. Containment profile in one-piece aluminium and melamine background. Load capacity 20kg per shelf. Not reversible.

CODE	Door	Soft	H
FLY3STM2DX (R)	45	✓	680 ± 25
FLY3STM2SX (L)	45	✓	680 ± 25



Technical Details

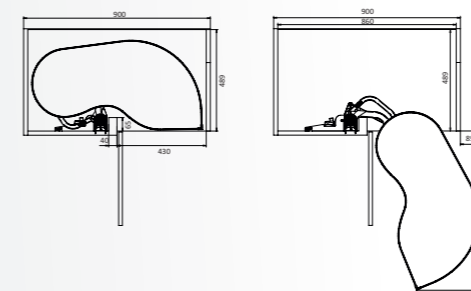

BASE & TALL PULLOUTS

Fly Box

Fly Box Base Mechanism

Fly Box angular mechanism for corner base with door 45. Prepared for n.2 tiers. With soft close. Reversible.

Fly Moon Shelves

Kit made up of n.2 pull-put shelves for Fly Box mechanism base. Containment profile in one-piece aluminium and melamine bottom. Reversible.

CODE	Door	Soft	H
FLYB45UGM	450	✓	560

CODE	W	D	H
FLYBST452VGF	450	500	90

Technical Details

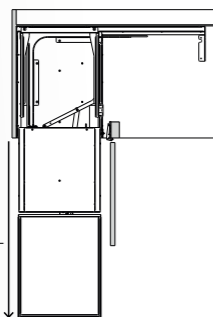
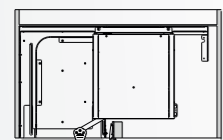
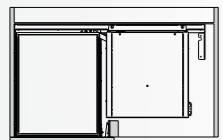

785

460

785



SHUTTER & DRAWER PROFILES



Shutter & Drawer Profiles, Plinths, Legs & Accessories

Flat Gola Profile & Accessories

Horizontal Gola Profile

Code 103A Chrome

Product Feature:

- *Aluminium profile in chrome finish.
- *Dripless plastic joint.
- *Different joints: Inner or outer
- *Profile length: 4087mm
- *Profile used below kitchen top.

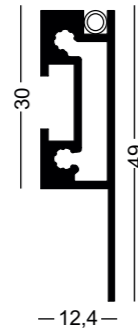

Horizontal Gola Profile

Code: 194A Chrome

Product Feature:

- *Aluminium profile in chrome finish.
- *Dripless plastic joint.
- *Different joints: Inner or outer
- *Profile length: 4187mm
- *Profile used for two door cabinet.

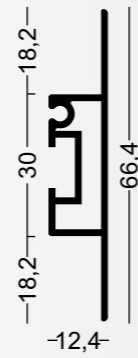

Outer Corner Joint 90°

Code 195A Closed & Opera

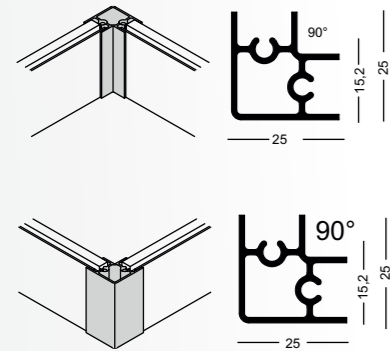

Inner Corner Joint 90°: Code SQ16

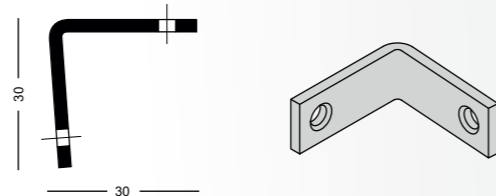

Fixing Clip

Code 6031

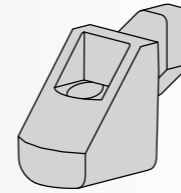

Handle

Code 1246

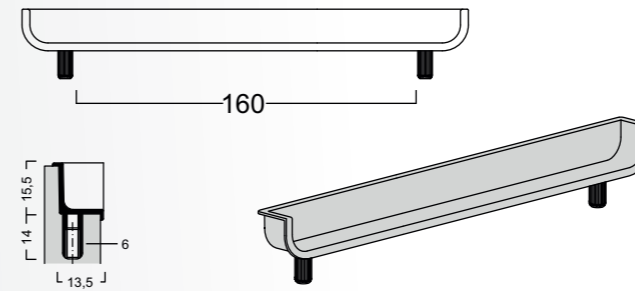

Spacer

Code 6016

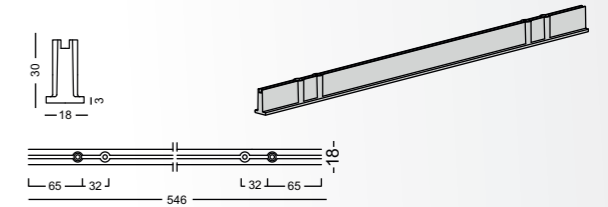

Handle

Code 1208

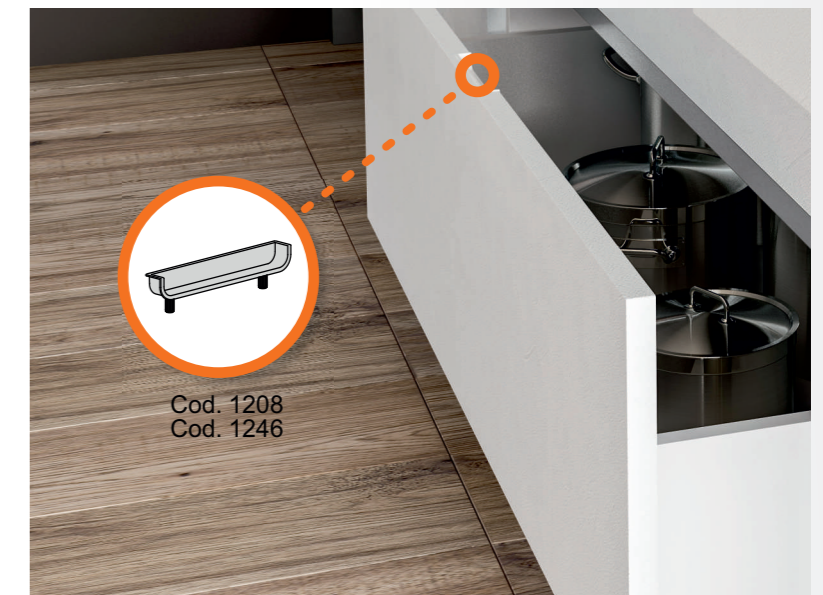
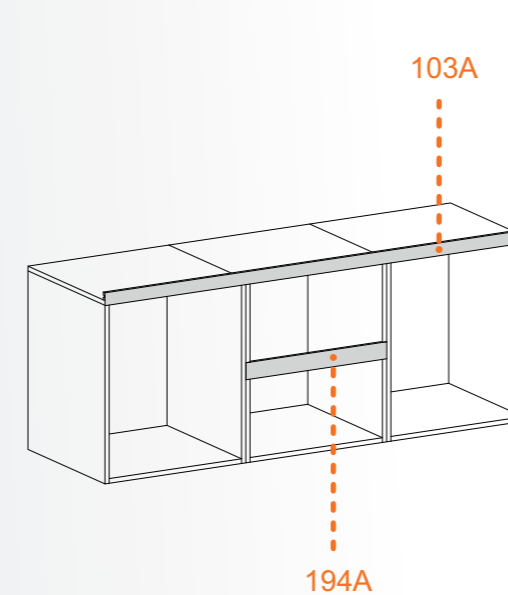
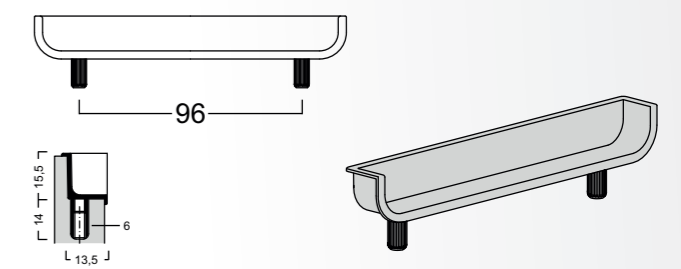

Gola Profile C, J, L & Accessories: Anodised and Brill



Horizontal Gola System (C & J)

Product Feature:

Finish: Anodized silver and Chrome Finish.

Gola Profile-Gola Profile-C for lower or two drawers.
Gola Profile-J for upper or single drawer.

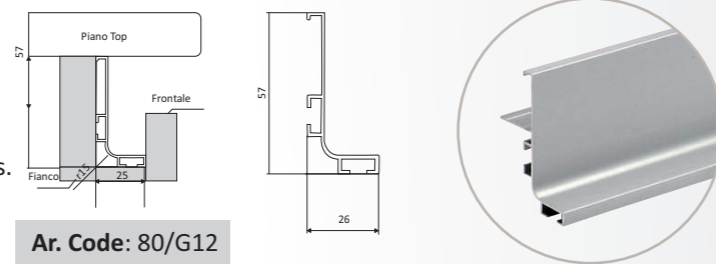

Article Number:

Ar. Code	Finish	Length
80/G12 AL07	Anodized	4.2 mtr
80/G12 AL01	Chrome	4.2mtr
80/G13 AL07	Anodized	4.2mtr
80/G13 AL01	Chrome	4.2mtr

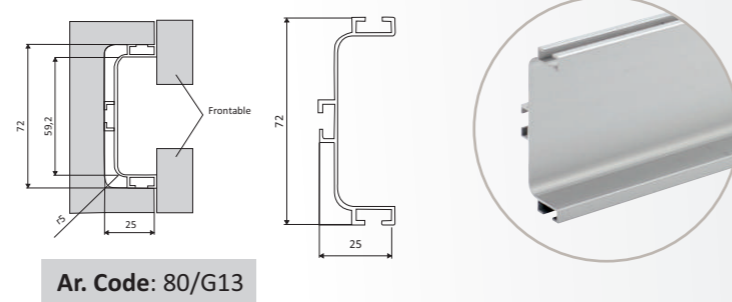

Application: It is used for kitchen design with seamless handle profile.

Wall Gola System (L Gola)

Product Feature:

Concealed Profile used on wall units.

Finish: Anodized silver and Chrome Finish.

Article Number:

Ar. Code	Finish	Length
80/G14 A90A 07	Anodized	4.2mtr
80/G14 A90A 01	Chrome	4.2mtr

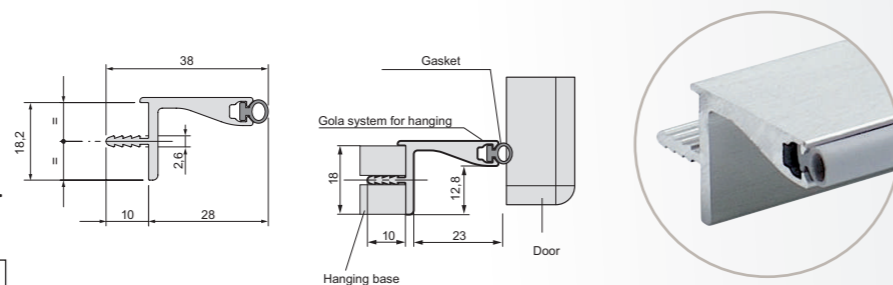

Application: This Gola profile can be used in place of a door or drawer handle.

Horizontal Gola Profiles: Caps And Corners

Product Feature:

Finish: Anodized silver and Chrome Finish.

Profile articles shows, for which profile this cap is useful.

Article Number:

Ar. Code	Finish
81/G11 AT2	End Caps for L Gola Horizontal
81/G11 AT1AL or 81/G13 AT1AL	Profile / Kit Fixing or Accessories
81/G13 AT2	Ends Caps for C Gola Horizontal

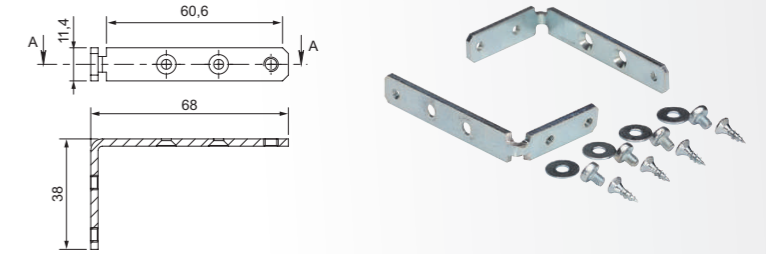

Profile Fixing Accessories Kit

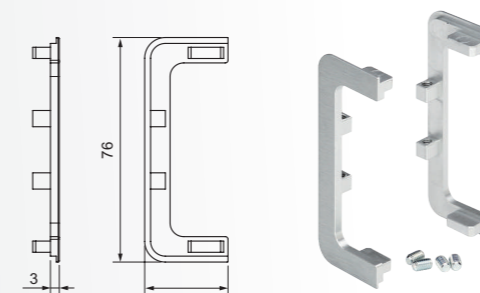

81/G11 AT1AL / 81/G13 AT 1AL

Application: It is used with Horizontal Gola profiles.

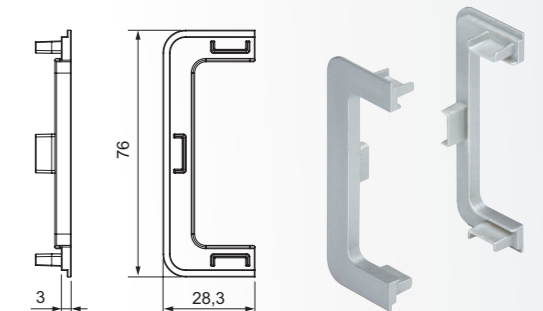

81/G13 AT2

90° Aluminium Internal Corner

Product Feature:

It is used with Horizontal C Gola Profile.

Finish: Anodized silver and Chrome Finish.

Article Number:

Ar. Code	Finish
80/G11 A90B 07	Anodized
80/G11 A90B 01	Chrome

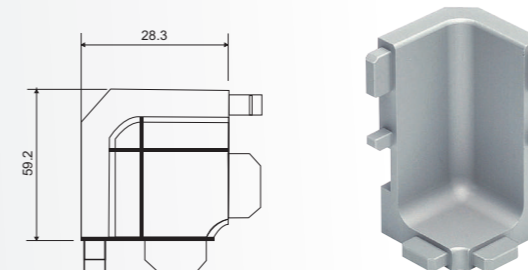

90° Aluminium External Corner

Product Feature:

It is used with Horizontal C Gola Profile.

Finish: Anodized silver and Chrome Finish.

Article Number:

Ar. Code	Finish
80/G11 A90A 07	Anodized
80/G11 A90A 01	Chrome

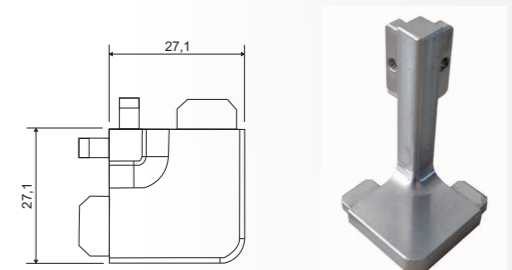

Gola Profile Single & Double Vertical

Single Vertical Gola Profile

Product Feature:

Used on tall units when you have an opening door on one side only.

Designed for handle-less furniture especially vertical tall units.

Finish: Anodized silver and Chrome Finish.

Article Number:

Ar. Code	Finish	Length
80/G16 A90A 07	Anodized	4.7mtr
80/G16 A90A 01	Chrome	4.7mtr

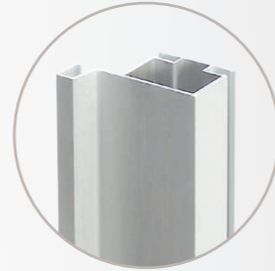
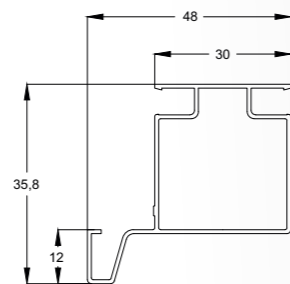

Application: It is used for larder pull-out in kitchen, wardrobe shutters, etc.

Double Vertical Gola Profile

Product Feature:

Used on tall units when two opening doors meet.

Designed for handle-less furniture especially vertical tall units.

Finish: Anodized silver and Chrome Finish.

Article Number:

Ar. Code	Finish	Length
80/G15 A90A 07	Anodized	4.7mtr
80/G15 A90A 01	Chrome	4.7mtr

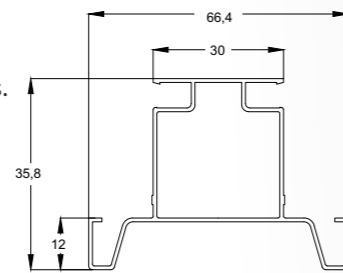

Application: This profile is use in between two tall larder or appliance units.

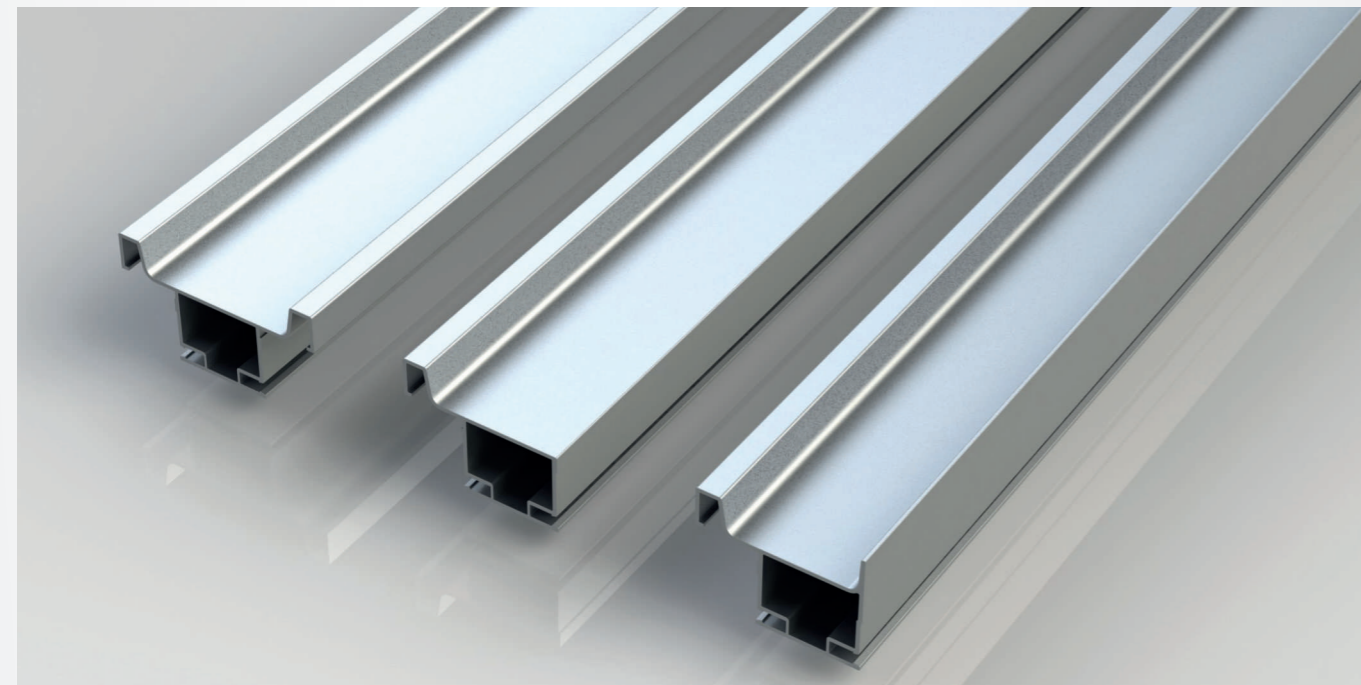

Plinths System & Accessories (Silver, Black, White & Mirror)

PVC Plinth System

Product Feature:

Finish: Silver, Black, White & Mirror in 4mtr. Length.

Available in 100mm & 150mm heights.

Article Number:

Ar. Code	Finish	Height
20/10.400.421	Black	100mm
20/10.400.32	Alusilver	100mm
20/10.400.44	Mirror	100mm
20/10.400.418	White	100mm
20/15.400.421	Black	150mm
20/15.400.32	Alusilver	150mm
20/15.400.44	Mirror	150mm
20/15.400.418	White	

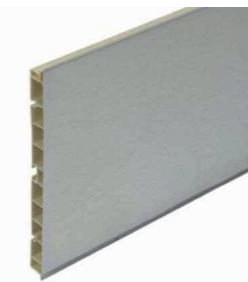
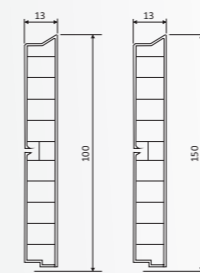

Application: It is used in Kitchen cabinets to prevent dust and water to settle down under the cabinet area.

Joint Straight Connector

Product Feature:

Finish: Silver, Black, White & Mirror.

Available in 100mm & 150mm heights.

Article Number:

Ar. Code	Finish	Height
21/19.20.421	Black	100mm
21/19.20.32	Alusilver	100mm
21/19.20.45	Mirror	100mm
21/19.20.418	White	100mm
21/19.25.421	Black	150mm
21/19.25.32	Alusilver	150mm
21/19.25.45	Mirror	150mm
21/19.25.418	White	150mm

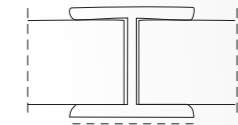

Application: To connect two straight skirting's.

Multi Corner Joint 90°

Product Feature:

Finish: Silver, Black, White & Mirror.

Available in 100mm & 150mm heights.

Article Number:

Ar. Code	Finish	Height
21/19.50.421	Black	100mm
21/19.50.32	Alusilver	100mm
21/19.50.45	Mirror	100mm
21/19.50.418	White	100mm
21/19.55.421	Black	150mm
21/19.55.32	Alusilver	150mm
21/19.55.45	Mirror	150mm
21/19.55.418	White	150mm

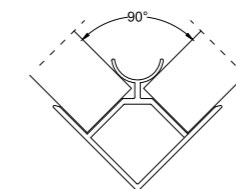

Application: PVC corner 90° for joint PVC skirting corner.

End Corner

Product Feature:

Finish: Silver, Black, White & Mirror.

Available in 100mm & 150mm heights.

Article Number:

Ar. Code	Finish	Height
21/19.40.421	Black	100mm
21/19.40.32	Alusilver	100mm
21/19.40.45	Mirror	100mm
21/19.40.418	White	100mm
21/19.45.421	Black	150mm
21/19.45.32	Alusilver	150mm
21/19.45.45	Mirror	150mm
21/19.45.418	White	150mm

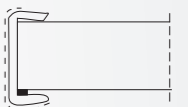

Application: To cover end section of skirting's.

PVC Adjustable Legs and clip

Product Feature:

Height adjustment legs with screw.

Available in 100 and 150mm heights.

Load capacity: 400kgs

Types: Oval base and Triangular Base.

Article Number:

Ar. Code	Description	Height
10/05.25.1010	Threaded Base with Dowel Dia	100mm
10/25.A100	Plastic Tube for Threaded Base	100mm
10/05.0363	Oval Base Dia	100mm
10/30.A100	Plastic Tube for Oval Base	100mm
10/25.A150	Plastic Tube for Threaded Base	150mm
10/30.A150	Plastic Tube for Oval Base	150mm
10/06.151	Clip For PVC Plinth	150mm

Application: Better stability for base supporting vertical panel.

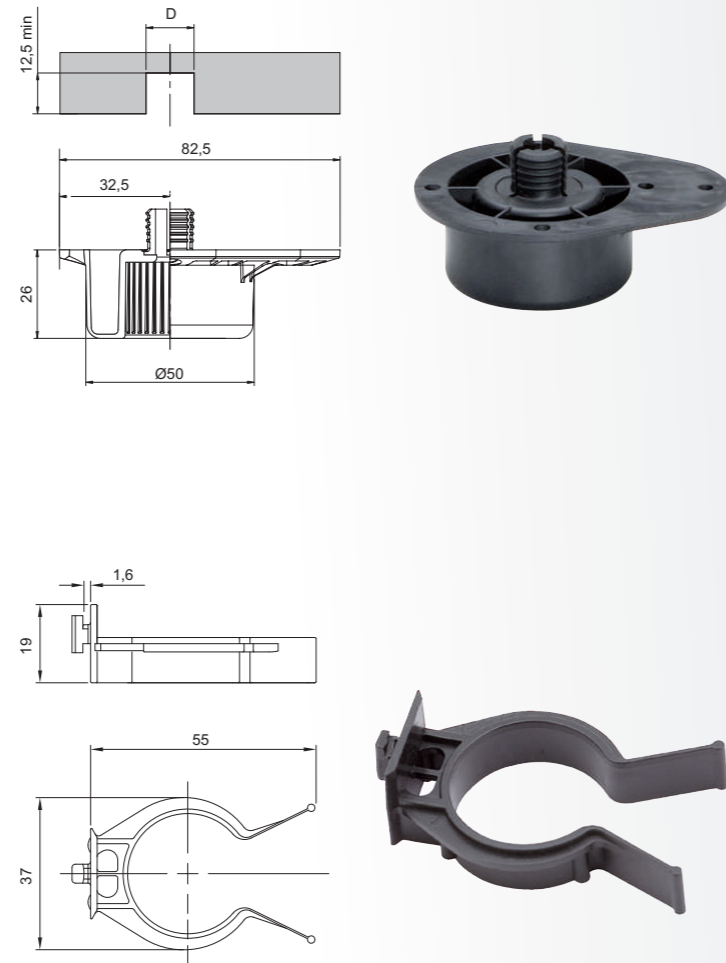
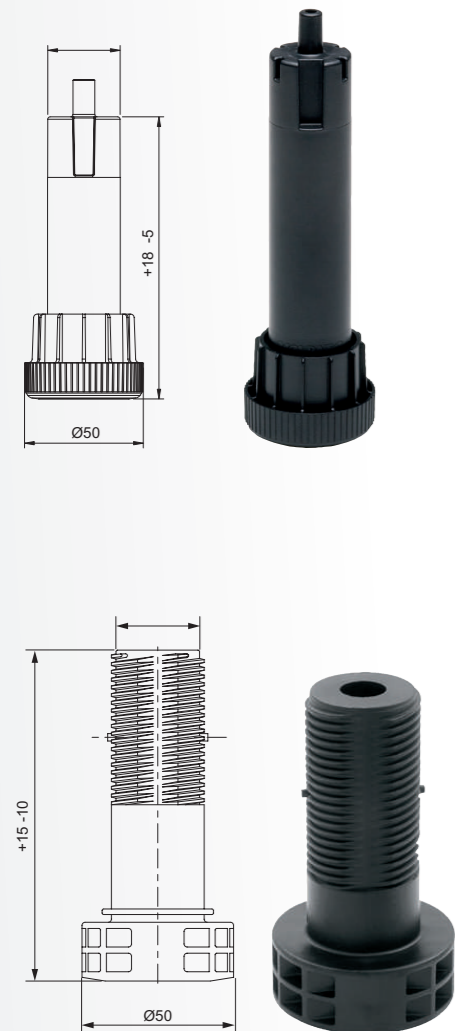
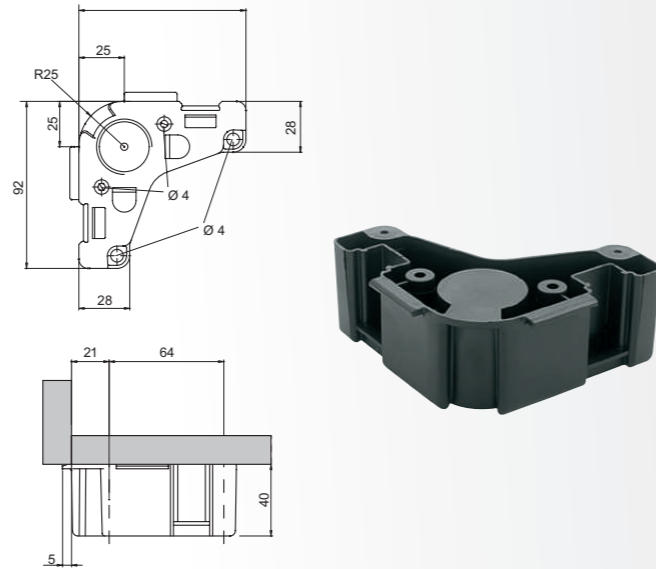

Hinges

Soft Close Full Overlay Hinge

Code: E61310AB

Product Feature:

- *High quality, durability and functionality.
- *Dia of hinge cup: 35mm, opening angle 110°.
- *Clip on cabinet hinge with 2D adjustment.
- *Open & close cycle time: 80000 times.
- *Nickel plated finish.

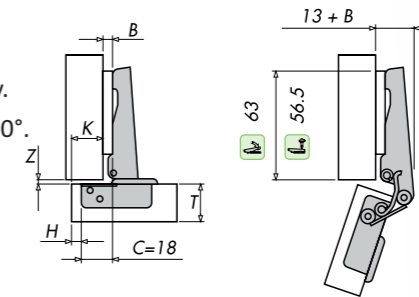

Soft Close Half Overlay Hinge

Code: E62310AB

Product Feature:

- *High quality, durability and functionality.
- *Dia of hinge cup: 35mm, opening angle 110°.
- *Clip on cabinet hinge with 2D adjustment.
- *Open & close cycle time: 80000 times.
- *Nickel plated finish.

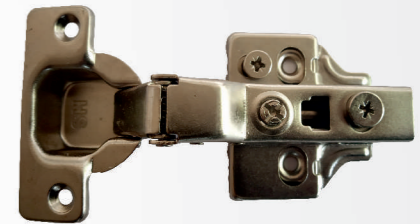
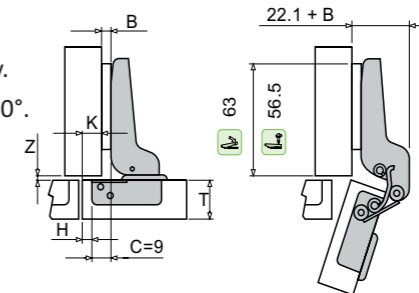

Soft Close Hinge Blind Corner

Code: E78310AN

Product Feature:

- *High quality, durability and functionality.
- *Dia of hinge cup: 35mm, opening angle 95°.
- *Clip on cabinet hinge with 2D adjustment.
- *Open & close cycle time: 80000 times.
- *Nickel plated finish.

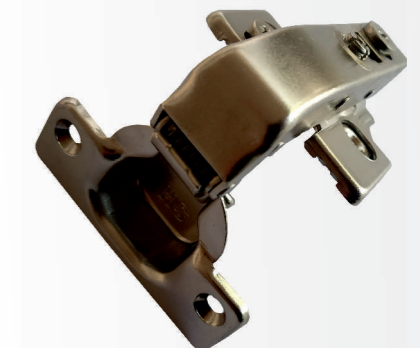
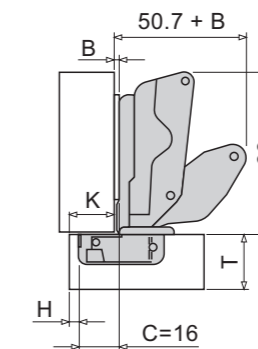

Soft Close Hinge 165 Degree

Code: E41310AN

Product Feature:

- *High quality, durability and functionality.
- *Dia of hinge cup: 35mm, opening angle 165°.
- *Clip on cabinet hinge with 2D adjustment.
- *Open & close cycle time: 80000 times.
- *Nickel plated finish.

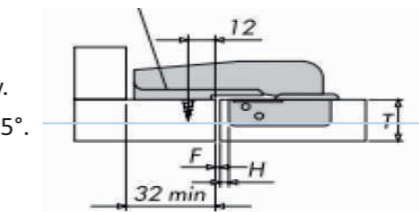

OTHER ACCESSORIES



HANDLES

Aluminium Table System

Product Feature:

Profiles designed for table manufacturing. Top panel not included.

Article Number:

Ar. Code	Item Needed For Table System
80/B2 F00 00	All Table Traversal Profile 60 (4.6mt lth.)
80/B2.K740Gun	Kit 4 Gambe Tav60 H.740/C/Acs

Application: Multiple use.

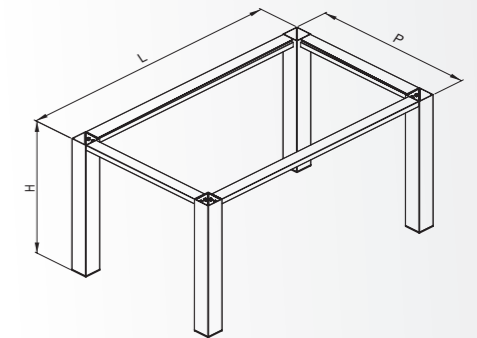

Handles

Handle Code: 0948



Dimension: L: 200 H: 30 W: 18

Material: ZAMAK

Centre Distance: 160-192mm

Handle Code: 0984



Dimension: L: 168 H: 29 W: 23

Material: ZAMAK

Centre Distance: 160mm

Handle Code: 1291



Dimension: L: 170 H: 27 W: 25

Material: ZAMAK

Centre Distance: 160mm

Handle Code: 1300



Dimension: L: 210 H: 19 W: 26

Material: ZAMAK

Centre Distance: 160mm

HANDLES

Handle Code: 1319



Dimension: L: 106 H: 25 W: 35
Material: ZAMAK
Centre Distance: 96mm

Handle Code: 1320



Dimension: L: 170 H: 25 W: 35
Material: ZAMAK
Centre Distance: 160mm

Handle Code: 1321



Dimension: L: 330 H: 25 W: 35
Material: ZAMAK
Centre Distance: 320mm

Handle Code: 1349



Dimension: L: 201 H: 28 W: 9
Material: ZAMAK
Centre Distance: 160-192mm

Handle Code: 1350



Dimension: L: 297 H: 28 W: 9
Material: ZAMAK
Centre Distance: 256-288mm

Handle Code: 1351



Dimension: L: 345 H: 28 W: 9
Material: ZAMAK
Centre Distance: 320mm

HANDLES

Handle Code: 1357



Dimension: L: 330 H: 25 W: 27
Material: ZAMAK
Centre Distance: 320mm

Handle Code: 1424



Dimension: L: 200 H: 25 W: 10
Material: ZAMAK
Centre Distance: 160mm

Handle Code: 1425



Dimension: L: 360 H: 35 W: 10
Material: ZAMAK
Centre Distance: 320mm

Handle Code: 1429

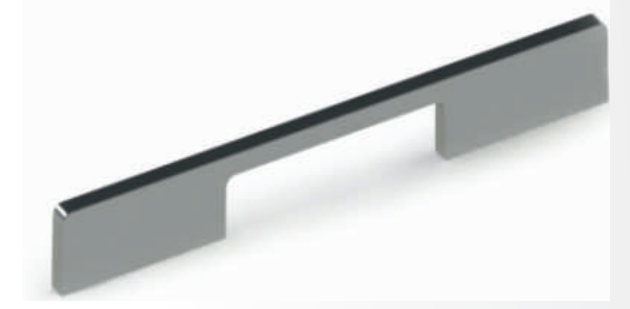

Dimension: L: 250 H: 30 W: 8
Material: ALUMINIUM
Centre Distance: 160-224mm

Handle Code: 1436



Dimension: L: 199 H: 30 W: 8
Material: ALUMINIUM
Centre Distance: 160-192mm

Pull Grip Handle

Product Description

Code	Available Size	Material
3588	L 297	Aluminium
3588	L 397	Aluminium
3588	L 447	Aluminium
3588	L 497	Aluminium
3588	L 597	Aluminium
3588	L 897	Aluminium



Product Description

Code	Available Size	Material
3624	447	Aluminium
3624	497	Aluminium
3624	597	Aluminium
3624	897	Aluminium

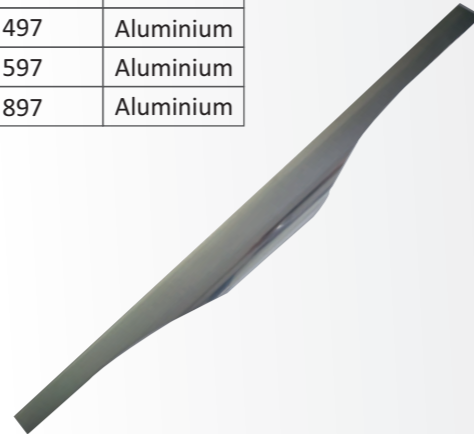

Overhead Cabinet Fitting (Overmax)

Product Feature:

- *It is very elegantly designed for moderate kitchen look.
- *Kitchen wall cabinet door system with patented synchronised opening movement.
- *Suitable for both wooden & glass alu. frame doors.
- *The handle has to be fixed in the upper front to the lower front.
- *Maximum door weight 5 kgs.



Article Number:

Ar. Code	Height	Thickness
07.0600.00.51	600	18mm
07.0720.00.51	720	18mm

Technical Details

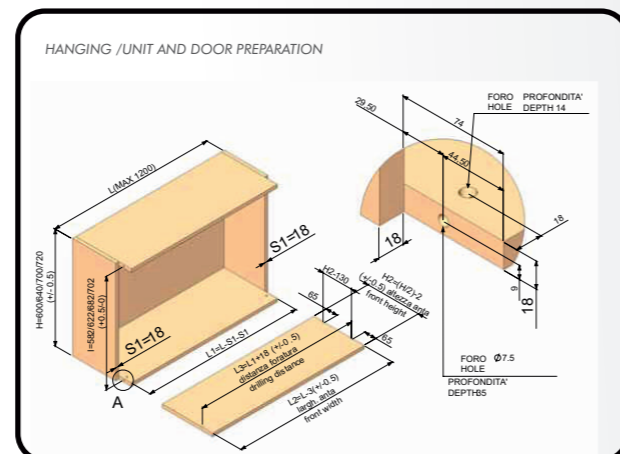
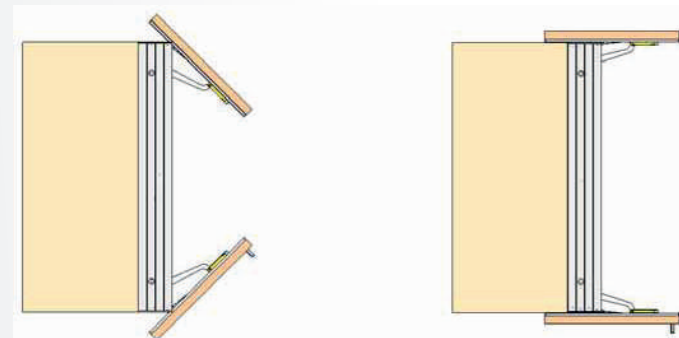

Connector Fitting (Dowel) for 18mm

This fitting have cylindrically shaped metal nut (i.e., a metal dowel) that is used to join two pieces of wood.

Article	Ø	L	M	i			
BO93	15	14,2	M8	9	18	1,000	10,3

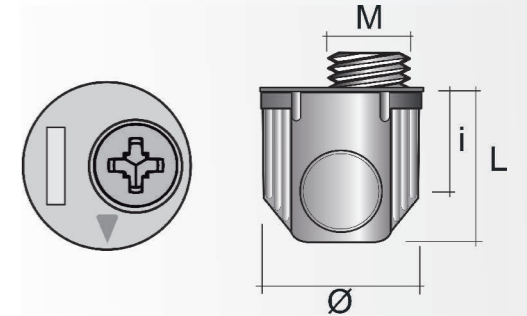

Article	Ø	F	M	L		
TF80	7	21	M6	8,5	2,000	12,5

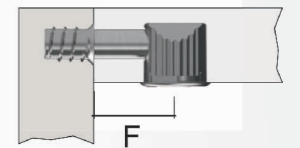
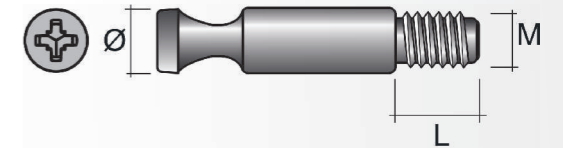

Article	CH	L	M		
BU12	8	12	M6	5,000	11,1

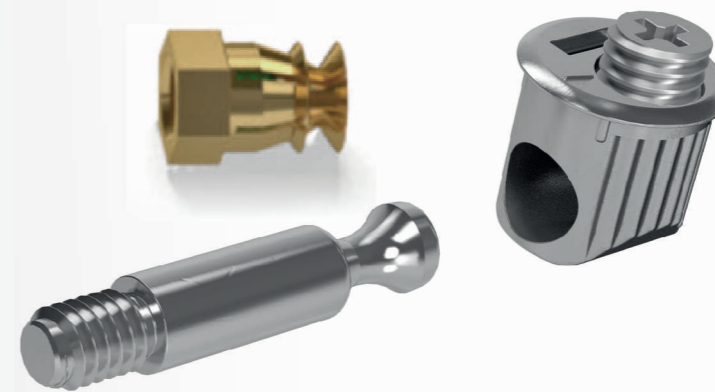
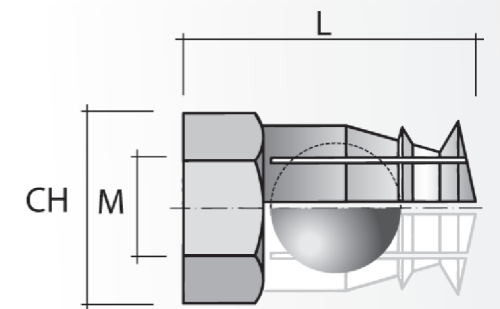

CONNECTING FITTINGS FOR KITCHENS & WARDROBES

Shelf Support (Flips)

This shelf support design allows easy, fast, and safe installation of shelves. The unique concept allows downward on to the side dowels until it is safely locked in position by a clicking sound.

Article	M	L		
PV23	6EURO	11	2,500	10,3

Article	Ø	L	I		
SI21	15	13,7	9,0	5,000	8,1

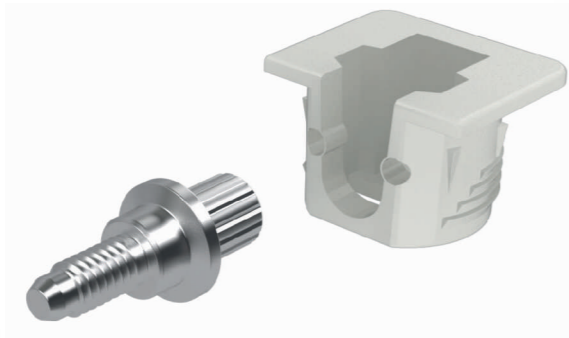
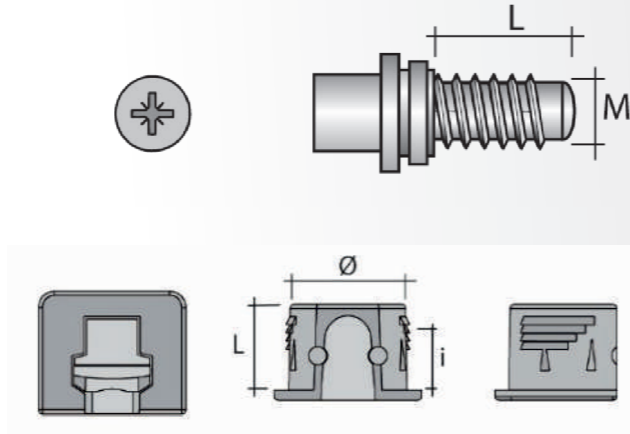

Connectors for Cabinet

Screws and Sleeves are Nickel plated for good aesthetics. Used to join boards of various thickness ranging from 32- 48mm

Article	Ø	L	M		
VF57	5	27	M4	2,000	6,8

Article	L	M		
VC57	15	M4	5,000	15,4

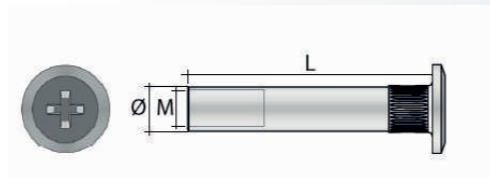

CONNECTING FITTINGS FOR KITCHENS & WARDROBES

Adjustable Levellers 60mm

This Adjuster leveller used in modular office furniture, Workstation and several other furniture items manufacturing.

Article	F	i	i1	Ø	H1	H		
PI91	21	9	16	15	18	min 59 max 74	100	9,5

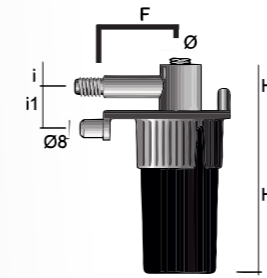

Shelf Support (Block)

Is the new concept in wood shelf supports, to be slotted into the panel by making face borings. It allows to join together any side and shelf, including bottom and top, without using any further connecting fitting.

Article	L			
SO011	14,2	18/19	5,000	19,1

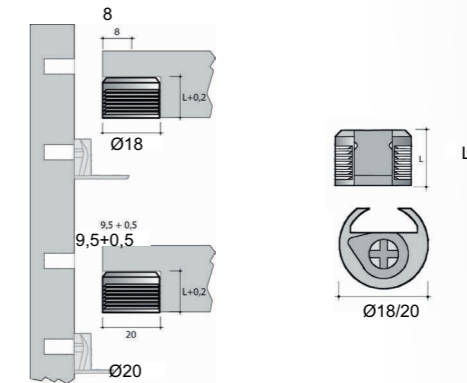

Article	I			
SO032	9	18/19	1,000	5,2

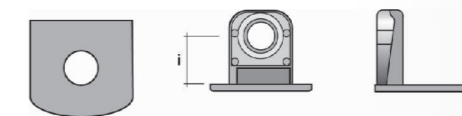

VARUN IMPEX

Address:

Gala No.1 & 4, Plot No.21, Papy
Industrial Estate, Umela Phata,
Vasai Road (West), Palghar - 401207.
Mob.: +91 9167883194
Email: varunimpexkba@gmail.com
Website: www.varunimpex.in